

| ITEM | QTY | PART NO. |
|------|-----|----------|
| *    | *   | *****    |

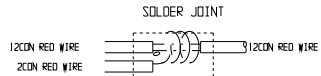

REMOVE A SMALL AREA OF INSULATION FROM THE 12CON RED WIRE, THEN WRAP THE 2CON RED WIRE AROUND THIS AREA, SOLDER AND APPLY SHRINKTUBING.

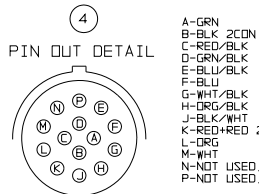

| N# | PART NUMBER | QTY | PART DESCRIPTION                              |
|----|-------------|-----|---|
| 1  | 231-250     | 1*  | SHRINKTUBING .250" BLK                        |
| 2  | 252-064     | 6'  | CABLE 12CON 18GA PVC GRY                      |
| 3  | 252-998     | 10' | CABLE 2CON 14GA PVC FLAT GRY                  |
| 4  | 255-228     | 1   | CONN DEUT H030 RCPT SZ10-14 PIN STRAIN RELIEF |
| 5  | 255-977     | 12  | CONT DEUT PIN 16-18GA                         |
| 6  | 255-979     | 2   | CONT DEUT CAVITY PLUG                         |

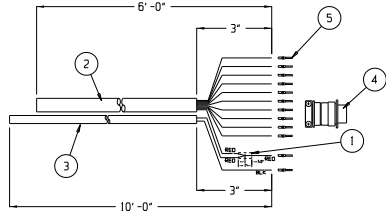

- NOTES:
1. NOT SHOWN: (B)
  2. REMOVE 3" OF OUTER JACKET BEFORE ASSEMBLING CONNECTOR.
  3. CUT OFF 12CON BLK WIRE
  4. SOLDER JOINT NEEDS TO BE INSIDE CONNECTOR AFTER ASSEMBLY.

| N# | PART NUMBER | QTY | PART DESCRIPTION                               |
|----|-------------|-----|--|
| 1  | 212-010     | 2   | SCREW PHIL PAN BLK #6X1                        |
| 2  | 212-011     | 2   | SCREW SOCKET CAP BLK 3/8-30 X 1                |
| 3  | 212-012     | 2   | SCREW PHIL PAN BLK #6X0.5                      |
| 4  | 212-108     | 1   | BOLT 1/4"-20 X .5"                             |
| 5  | 213-006     | 2   | NUT HEX 5MM                                    |
| 6  | 213-010     | 8   | NUT JAM 15/32" CHROME                          |
| 7  | 213-442     | 1   | NUT HEX NYLON 1/4"-20                          |
| 8  | 214-002     | 10  | CABLE TIE BLACK 7"                             |
| 9  | 219-014     | 1   | BRKT RCS MAGNET MOUNT                          |
| 10 | 219-016     | 1   | MAGNET CERAMIC ROUND 3.25" DIA                 |
| 11 | 230-003     | 1*  | FOAM .750" TD BLK                              |
| 12 | 230-057     | 1   | BAG PDLY CLR 14 X 18 2MIL W/LOGO               |
| 13 | 232-050     | 2   | DECL S/N (SILVER)                              |
| 14 | 232-415     | 1   | DECAL RCS BRADCO BC TREE SPADE                 |
| 15 | 250-141     | 8   | SW TOG DPDT 3P MOM MICRO .488" BAT             |
| 16 | 251-021     | 1   | ENCL RCS RIGHT HALF 4 BUT                      |
| 17 | 252-059     | 1'  | WIRE 18GA RED                                  |
| 18 | 254-111     | 1   | DIODE RECTIFIER 1N5400 3A 50V SILICON 00-201AD |
| 19 | 255-030     | 1   | TRM SPLICE CLOSED END                          |
| 20 | 259-017     | 1   | LODM CLAMP RCS HANDLE                          |
| 21 | 300-010     | 1   | FUSE KIT 10A ATC                               |
| 22 | 308-374     | 1   | ENCL RCS LEFT NOTCHED                          |
| 23 | 315-006     | 1   | HRN 12CON 18GA DEUT H030 RCPT 14R(12) 6"       |

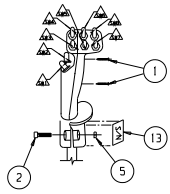

HARNESS INSTALLATION DETAIL

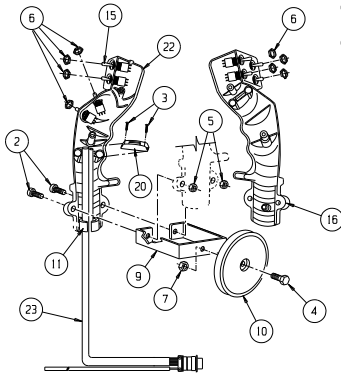
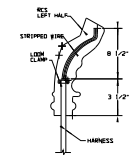

SWITCH ORIENTATION:

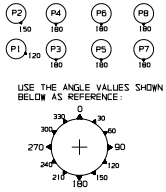

- NOTES:
1. USE 1 CABLE TIE TO SECURE WIRES INSIDE HANDLE
  2. NOT SHOWN (B) (12) (21)

WIRING DIAGRAM

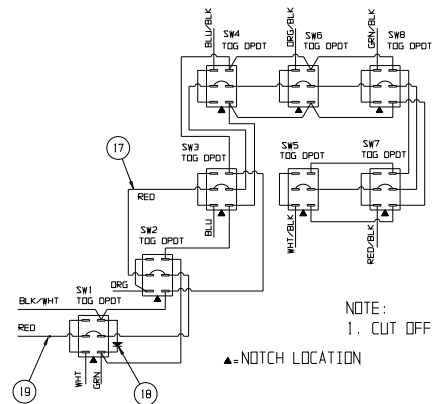

SUPPLIER: FASSE VALVE  
PART NUMBER: 319-143

| BLK | QTY |
|-----|-----|
|     |     |

| TOLERANCE                  | REV | NO | DATE     | BY | CHKD | DATE | BY | DESCRIPTION |
|----------------------------|-----|----|----------|----|------|------|----|-------------|
| DECIM                      | E   | 1  | 12-22-03 | JS |      |      |    |             |
| FRAC                       | D   | 1  | 12-22-03 | JS |      |      |    |             |
| ANGLES                     | C   | 1  | 12-22-03 | JS |      |      |    |             |
| UNLESS OTHERWISE SPECIFIED | B   | 1  | 12-22-03 | JS |      |      |    |             |
|                            | A   | 1  | 01-13-04 | JK |      |      |    |             |

| TITLE               | SCALE | DATE     | BY | CHKD | DATE | BY | DESCRIPTION |
|---------------------|-------|----------|----|------|------|----|-------------|
| JOYSTICK ASSEMBLY   | 1:1   | 12-22-03 | JS |      |      |    |             |
| PRODUCT: TREE SPADE |       |          |    |      |      |    |             |
| ATTACHED TO: 25425  |       |          |    |      |      |    |             |