

**M** MKMARTIN



**M**  
MKMARTIN

**LIVING  
COUNTRY**

EQUIPMENT FOR RURAL PROPERTY CARE



**7** YEAR  
WARRANTY

# TABLE OF CONTENTS



**Auger Snowblowers**

Page 04



**Pull Type Snowblowers**

Page 08



**Loader Mounts & Power Packs**

Page 10



**Skidsteer Rotary Cutters**

Page 15



**3PH Rotary Cutter**

Page 16



**Rotary Cutters -Wing**

Page 22



**Axis Tool Arm**

Page 30



**3PH Box Blades**

Page 32



**Track Curry**

Page 33



**Land Levelers**

Page 41



**3PH Rotary Tillers**

Page 42



**Cultivator**

Page 44



**3PH Dump Boxes**

Page 47



**Gravity Boxes**

Page 48



**Stack N Fold Toolbar**

Page 52



**Skidsteer  
Snowblower**

Page 12



**Self Powered  
Snow Throwers**

Page 13



**Steiner/Ventrac  
Snowblowers**

Page 14



**Finishing Mowers**

Page 24



**Trail/UTV Mower**

Page 26



**Lawn Sweepers**

Page 28



**Grader Blades**

Page 34



**Grader Levelers**

Page 38



**Land Planes**

Page 40



**Landscape Rake**

Page 44



**Garden Hillers**

Page 45



**3PH Weight Boxes**

Page 46



**Disc Mower  
Implement Caddy**

Page 53



**Implement Caddy**

Page 54

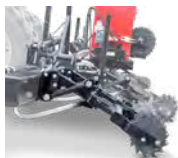

**Interseeder**

Page 55

# Single Auger Snowblowers



MK Martin's Meteor series 3PH snowblowers are built to get your work off the ground with durable performance and high-capacity design. The Meteor lineup is available in a range of models for 12 HP compact tractors to 20 HP farm tractors. Meteor snowblowers are available in single auger, double auger, pull type, and skidsteer models.

Models	SB48	SB54	SB60
<b>HP (Rec.)</b>	12 HP	15 HP	20 HP
<b>Cutting Width</b>	48"	54"	60"
<b>Cutting Edge</b>	1/4 x 1-1/2	3/8 x 1	3/8 x 1
<b>Auger Diam.</b>	12"	14"	14"
<b>Fan Diam.</b>	19"	21"	21"
<b>Chute Diam.</b>	7"	8"	8"
<b>Chute Rotation</b>	Manual Included		
<b>Chute Deflector</b>	Manual	Manual Standard/ Hydraulic Option	
<b>Main Body Height</b>	22.5"	25"	25"
<b>3PH Mount</b>	CAT. 1	CAT. 1	CAT. 1
<b>Weight (LBS.)</b>	266	366	396



## Features

- 7 Year limited warranty
- High tensile steel flighting
- 3PH quick attach compatible
- 5 blade fan/impeller
- SB48, SB54, and SB60 comes standard with manual rotators
- Manual chute deflector

Models	SB68	SB72	SB78	SB87	SB97
<b>HP (Rec.)</b>	30 HP	35 HP	50 HP	60 HP	75 HP
<b>Cutting Width</b>	68"	72"	78"	87"	97"
<b>Cutting Edge</b>	3/8 x 1	3/8 x 1	1/2 x 1-1/2	1/2 x 2	1/2 x 2
<b>Auger Diam.</b>	14"	14"	15"	19"	19"
<b>Fan Diam.</b>	21"	21"	23"	27"	27"
<b>Chute Diam.</b>	10"	10"	10"	12"	12"
<b>Chute Rotation</b>	Select Option				
<b>Chute Deflector</b>	Manual Standard/ Hydraulic Option				
<b>Main Body Height</b>	25"	25"	29"	36"	36"
<b>3PH Mount</b>	CAT. 1	CAT. 1	CAT. 1 & 2	CAT. 2	CAT. 2
<b>Weight (LBS.)</b>	506	540	748	1,034	1,106

# Double Auger Snowblowers



Models	SB87D	SB97D	SB108D	SB120D
<b>HP (Rec.)</b>	60 HP	100 HP	125 HP	200 HP
<b>Cutting Width</b>	87"	97"	108"	120"
<b>Cutting Edge</b>	1/2 x 2	1/2 X 6*	1/2 x 6*	1/2 x 6*
<b>Auger Diam.</b>	15" (x2)	15" (x1) 19" (x1)	15" (x1) 19" (x1)	15" (x1) 23" (x1)
<b>Fan Diam.</b>	27"	32"	32"	36"
<b>Chute Diam.</b>	12"	13"	13"	13"
<b>Chute Rotation (Man/Hyd)</b>	Opt/Opt	NA/Std	NA/Std	NA/Std
<b>Chute Deflector (Man/Hyd)</b>	Std/Opt	Std/Opt	Std/Opt	Std/Opt
<b>Main Body Height</b>	36"	43"	43"	47"
<b>3PH Mount</b>	CAT. 2	CAT. 2 & 3	CAT. 2 & 3	CAT. 2 & 3
<b>Weight (LBS.)</b>	1,161	1,900	1,980	3,010

## PTO Options

Models	HP	Shaft	RPM
<b>87D/97D/108D</b>	100-125	6 Spline	540
<b>97D175/108D175</b>	125-175	6 Spline	540
<b>97DF1.75/108DF1.75</b>	125-175	1 3/4" 20 Spline	1,000
<b>97DF/108DF</b>	125-175	1 3/8" 21 Spline	1,000
<b>SB120D</b>	150-200	6 Spline	540
<b>SB120 DF 1.75</b>	150-200	1 3/4" 20 Spline	1,000
<b>SB120DF</b>	150-200	1 3/8" 21 Spline	1,000





### **3PH / Quick Attach**

All models are built standard with 3 point hitches in Category 1 or Category 2, and are Quick Attach compatible.

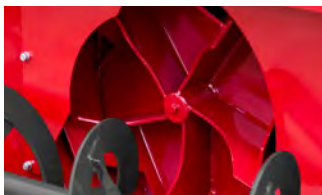

### **Five Blade Fan**

The Meteor five blade fan is ruggedly designed and built to quickly and consistently blow the snow out of the chute.



### **Gear Box**

The heart of Meteor's power train is the time-proven Comer gearbox.



### **Skid Shoes**

Adjustable skid shoes are included with all snow blowers to protect your surface and your blower.



### **1000 RPM PTO Kit**

Available for 97D, 108D, and 120D models, this kit allows larger tractors to run at 1000 RPM PTO. The 1000 RPM Kit also raises the input shaft to allow the PTO shaft to run at a lesser angle on larger tractors increasing the efficiency and life of the driveline components.

*PTO shaft not included.*

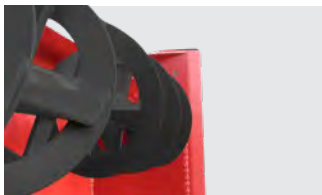

### **High Tensile Steel Ribbon Flighting**

To make sure you get the longest dependable service from your blower all Meteors have the highest quality High Tensile Steel Ribbon flighting on the auger providing strength to move the snow to the fan.

# Pull Type Snowblowers



## Optional Equipment

- Hydraulic/manual chute rotators
- Back drag (manual or hydraulic)
- Back drag (manual or hydraulic)
- Tivar contact surfaces

Models	SB54 P/T	SB60 P/T	SB68 P/T	SB72 P/T	SB78 P/T	SB87 P/T	SB97 P/T
<b>HP (Rec.)</b>	25 HP	25 HP	35 HP	35 HP	50 HP	60 HP	60 HP
<b>Cutting Width</b>	54"	60"	68"	72"	78"	87"	97"
<b>Cutting Edge</b>	Bolt On (1/2 x 4)						
<b>Auger Diam.</b>	14"	14"	14"	14"	15"	19"	19"
<b>Fan Diam.</b>	18"	18"	21"	21"	23"	27"	27"
<b>Chute Diam.</b>	8"	8"	10"	10"	10"	12"	12"
<b>Double Hood Deflector</b>	N/A	N/A	Std.	Std.	Std.	Std.	Std.
<b>Chute Rotation</b>	Manual (std.) or Hydraulic (opt.)						
<b>Chute Deflector</b>	std./opt.	std./opt.	opt./opt.	opt./opt.	opt./opt.	opt./opt.	opt./opt.
<b>Main Body Height</b>	25"	25"	25"	25"	28"	32-1/2"	32-1/2"
<b>3PH Mount</b>	CAT. 1	CAT. 1	CAT. 1	CAT. 1	CAT. 1 & 2	CAT. 2	CAT. 2
<b>Weight (LBS.)</b>	462	495	671	685	900	1,175	1,225





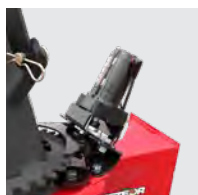
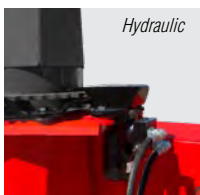
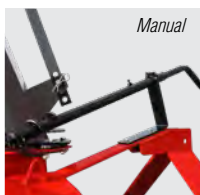

## **Chute Rotator**

Meteor Snow Blower chute rotators come in manual (crank), hydraulic (orbital motor), and electric.



## **Multi-Hinged Deflector**

Meteor's Multi Hinged Deflector provides you with finer control over where your snow is blown.

*Cylinder not included.*



## **Truck Loading Chute**

- Provides up to 40" of additional height
- Hydraulic Rotation
- Hydraulic Multi-Hinged Deflector



## **Hydraulic Chute Deflector**

Exit chute deflectors are available in manual or hydraulic (optional).

*Includes the cylinder and the hoses.*

# Loader Mount Snowblowers



Models	SBLM66	SBLM76	SBLM86
<b>Recommended HP</b>	40-60HP	40-60HP	40-60HP
<b>Max. Operating Weight</b>	8,000 LBS.	8,000 LBS.	8,000 LBS.
<b>Cutting Width</b>	66"	76"	86"
<b>Cutting Edge</b>	3/8" x 3"	3/8" x 3"	3/8" x 3"
<b>Skid Shoes</b>	3/8" x 1-1/2"	3/8" x 1-1/2"	3/8" x 1-1/2"
<b>Auger Tube</b>	3-1/2" OD	3-1/2" OD	3-1/2" OD
<b>Auger Flighting</b>	5/16 x 2-1/4	5/16 x 2-1/4	5/16 x 2-1/4
<b>Auger Diameter</b>	19"	19"	19"
<b>Roller Chain</b>	#60	#60	#60
<b>Hitch Plate</b>	Quick-tach	Quick-tach	Quick-tach
<b>Chute Rotation</b>	Hydraulic	Hydraulic	Hydraulic
<b>Chute Diameter</b>	12"	12"	12"
<b>Main Body Height</b>	31"	31"	31"
<b>Chute Deflector</b>	Hydraulic	Hydraulic	Hydraulic
<b>Fan Diameter</b>	26"	26"	26"
<b>Fan Depth</b>	8"	8"	8"
<b>Auger Drive</b>	Hydraulic	Hydraulic	Hydraulic
<b>Fan Drive</b>	Hydraulic	Hydraulic	Hydraulic
<b>Weight (LBS.) *</b>	970	1,015	1,065

\*Weight includes snowblower only



SBLMPP-30



SBLMPPCS-30

For use with loader mount hydraulic blowers. Available with the following Quick Tach: *(Must be specified at time of order)*

- Universal skidsteer
- Euro (ALO)
- JD 440/540 combination

Models	SBLMPP-30	SBLMPPCS-30
<b>Recommended HP</b>	40-60HP	40-60HP
<b>Capacity (gallons)</b>	30	30
<b>Flow Rate (PSI)</b>	30 GPM/2500 PSI	30 GPM/2500 PSI
<b>Mount</b>	3PH	3PH
<b>Weight</b>	535 LBS.	575 LBS.
<b>Height</b>	48"	48"
<b>Width</b>	39"	39"
<b>Depth</b>	30"	32"
<b>Max Operating Temp. (°C)</b>	2° C	30° C
<b>Max Operating Time (hours)</b>	2 Hour Duty Cycle	Full Duty Cycle
<b>Cooling System Included</b>	No	Yes

# Skidsteer Snowblowers



Meteor Snow Blowers for Skid Steer Loaders feature one piece, solid side plate construction for added strength and rigidity. They also feature an offset chute for better operator vision.

Models	SSB62	SSB66	SSB76	SSB86	SSB96
<b>Cutting Edge (Bolt-On)</b>	1/2 x 4	1/2 x 4	1/2 x 4	1/2 x 4	1/2 x 4
<b>Cutting Width</b>	62"	66"	76"	86"	96"
<b>Auger Diam.</b>	19"				
<b>GPM (min)</b>	14	14	14	23	33
<b>Mounting</b>	Universal Skidsteer Attach				
<b>Auger Diam.</b>	19"				
<b>Chute Diam.</b>	11"				
<b>Main Body Height</b>	31"				
<b>Chute Deflector</b>	Manual Std/Hydraulic Opt				
<b>Fan Diam.</b>	26"				
<b>Weight (LBS.)</b>	900	925	950	975	1025

Flow Rates	Code
14-17 GPM	A
18-20 GPM	B
20-22 GPM	B+
23-26 GPM	C
27-33 GPM	C+
33-40 GPM	D

Code "D" high flow package is recommended on the SSB 96.



## Wired Remote

The wired controller allows for remote engine start and shutdown.

Oversized buttons allows operators to make quick and accurate adjustment of the chute rotation.



Model	S1054E	S1060E
<b>Cutting Width</b>	47"	53"
<b>Motor Type</b>	Honda 13HP	Honda 13HP
<b>Electric Start</b>	12 Volt	12 Volt
<b>Clutch</b>	Electric (start/stop blower)	
<b>Rotor</b>	16" @ 750 RPM	
<b>Hood Rotator</b>	Electric	Electric
<b>Hood Deflector</b>	Manual	Manual
<b>Cutting Edge</b>	Bolt on 1/4" x 3-1/2"	
<b>Overall Width</b>	54"	60"
<b>Overall Depth</b>	36"	36"
<b>Main Body Height</b>	22.75"	22.75"
<b>Weight</b>	470 lbs.	545 lb.

# Steiner/Ventrac Snowblowers

**NEW  
PRODUCT**



## FEATURES

- Designed to fit Steiner and Ventrac tractor
- Hydraulic shoot rotation for smooth blowing
- Ideal for rural driveways and smaller commercial yards

Models	SBVEN48	SBVEN54
Cutting width	48"	54"
Cutting Edge	3/8 x 1"	
Auger Diam.	14"	
Fan Diam.	21"	
Chute Diam.	8"	
Chute Rotation	Hyd.	
Chute Deflector	Manual	
Body Height	25"	
Drive	Belt drive	
Mount	Steiner/Ventrac	
Weight (LBS.)	475	488

### Belt Drive



### Hydraulic Chute Rotate



### Steiner/Ventrac Mount







The hydraulically driven rotary cutter was designed for mowing grass and light brush, up to 2" in diameter. Available in 60" and 72" cutting widths the skidsteer mount cutter can cut almost any desirable height. With the standard 3 blades on the blade bar coupled with our unique float linkage, the rotary cutter follows the contour of your cutting area.

## FEATURES

- Maximum brush diameter 2"
- 3 blade cutting assembly
- Integrated push bar
- Relief valve for protection
- Chain curtain
- Floating linkage allows the cutter to follow ground contour

Model	Description	Brush Diameter	Deck Thickness	Weight (LBS.)
<b>PRCH60-A</b>	60" Rotary Cutter	2"	3/16"	760
<b>PRCH60-B</b>	60" Rotary Cutter	2"	3/16"	760
<b>PRCH60-B+</b>	60" Rotary Cutter	2"	3/16"	760
<b>PRCH72-A</b>	72" Rotary Cutter	2"	3/16"	860
<b>PRCH72-B</b>	72" Rotary Cutter	2"	3/16"	860
<b>PRCH72-B+</b>	72" Rotary Cutter	2"	3/16"	860
<b>PRCH72-C</b>	72" Rotary Cutter	2"	3/16"	860
<b>PRCH72-C+</b>	72" Rotary Cutter	2"	3/16"	860
<b>PRCH72-D</b>	72" Rotary Cutter	2"	3/16"	860

Flow Rates	Pack. Codes
<b>14-17 GPM</b>	A
<b>18-20 GPM</b>	B
<b>20-22 GPM</b>	B+
<b>23-26 GPM</b>	C
<b>27-33 GPM</b>	C+
<b>33-40 GPM</b>	D



*To ensure optimum performance, hydraulic output must match motor package.*

# 3PH Rotary Cutters



The PTO powered rotary cutters provide excellent mowing and shredding performance for tractors rated between 20-50 HP. The 3PH mount models are available in a variety of cutting widths, providing a cutting path from 48" - 72". To better adapt to your conditions, the rotary cutter features an adjustable cutting height of 2" - 10" and a floating top link. This combination allows you to get the ideal cut for your field or roadside.

Model	PRC48LD	PRC48	PRC60	PRC66	PRC72	PRC72HD
<b>Cutting Path</b>	48"	48"	60"	66"	72"	72"
<b>Shipping Weight (LBS.)</b>	320	380	500	560	625	635
<b>Tractor HP (min)</b>	20	20	30	40	50	50
<b>3PH Mount</b>	CAT. 1	CAT. 1	CAT. 1	CAT. 1	CAT. 1	CAT. 1
<b>PTO RPM</b>	540	540	540	540	540	540
<b>Blades</b>	1/2" x 3"	1/2" x 3"	1/2" x 3"	1/2" x 3"	1/2" x 3"	1/2" x 3"
<b>Tip Speed (Ft/Min)</b>	13100	13100	12462	13708	14955	14955
<b>Wheels</b>	16" (Air Filled)		16" (Segmented)			

*The Pulsar Rotary Cutter is backed by a 7 Year Limited Warranty.*



**Segmented Wheel**



**Fixed Skid Shoe**



**Pulsar Blade Assembly**



**Floating Top Link**



**Slip Clutch**



**Chain Curtain Option**

# 3PH Rotary Cutters - 700 Series



Model	MKRC748	MKRC760	MKRC766	MKRC772
<b>Cut Width</b>	48"	60"	66"	72"
<b>Weight (LBS.)</b>	420	535	605	640
<b>Hitch</b>	CAT. 1 Quick Hitch Compatible			
<b>Cutting Height</b>	1.5" - 13" / 10 Positions			
<b>Max Brush Diameter</b>	2"			
<b>Tip Speed (Ft/Min)</b>	13100	12462	13708	14955
<b>Wheels</b>	16" (Segmented)			
<b>Blades</b>	1/2" x 3"			
<b>Tractor HP (min)</b>	22	30	40	50
<b>PTO RPM</b>	540 RPM	540 RPM	540 RPM	540 RPM
<b>Gearbox Rating *</b>	40	60	60	60
<b>Deck</b>	10 ga	10 ga	10 ga	10 ga
<b>Deck Height</b>	7"	7"	7"	7"
<b>Skirt Thickness</b>	3/16"	3/16"	3/16"	3/16"
<b>Stump Jumper</b>	Yes (Round)	Yes (Round)	Yes (Round)	Yes (Round)
<b>Rubber Guard</b>	Std.	Std.	Std.	Std.
<b>Protection</b>	Shear Pin	Shear Pin	Shear Pin	Shear Pin



**7" Deck Height**



**CAT.1 3PH**



**Floating Top Link**



**Solid Segmented Wheels**



**Front & Rear Rubber Guards**

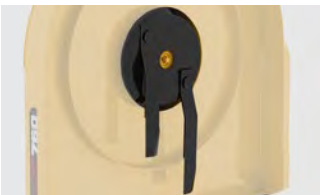

**2 Piece Blade Assembly**



**Deck Protection Ring**



**Stump Jumper**



**Fixed Skid Shoe**

# 3PH Rotary Cutters Plus



The rotary cutter for tractors comes rated between 30 - 80 HP. This updated mower features not only Category 1, but also Category 2 and Quick Tach mounting options to fit your equipment. With a cutting path ranging from 60" - 120", and a cutting height of 2" - 10" with the standard floating top link, this mower will get the job done the first time. To ensure even cutting and shredding every time, the deck is outfitted with 3 blades covering more area on each pass.

Model	PRCPLUS60	PRCPLUS72	PRCPLUS84	PRCPLUS96	PRCPLUS120
<b>Cutting Path</b>	60"	72"	84"	96"	120"
<b>Shipping Weight (LBS.)</b>	595	775	1045	1530	1610
<b>Tractor HP (min)</b>	30-40	60	60	80	80
<b>Hitch Type</b>	CAT. 1 & 2 Quick Tach compatible				Draw Bar Hitch
<b>PTO RPM</b>	540	540	540	540	540
<b>Blades</b>	3 - 1/2" x 3"	3 - 1/2" x 3"	3 - 1/2" x 3"	3 - 1/2" x 3"	6 - 1/2" x 4"
<b>Tip Speed (Ft/Min)</b>	12,462	15,260	17,803	16,500	14,500
<b>Wheel Type (Qty.)</b>	16" Segmented (1)	16"	16" Segmented (2)	16" Segmented (2)	16" Pneumatic (2)

*The Pulsar Rotary Cutter is backed by a 7 Year Limited Warranty.*



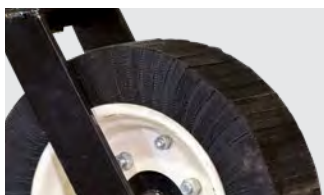

**Segmented Wheel**



**Chain Curtain Option**



**Blade Assembly**



**Floating Top Link**



**Slip Clutch**



**Bolt-On Skid Shoe**

# Rotary Cutters - Wing



The Rotary Cutter - Wing is available in a 15' model, the three triple blade assemblies make short work of stubble — whether in the pasture, field, or brush. Each wing can independently float 22° down and 33° up to conform to the contours of the ground. The 15' width of the cutter can be greatly reduced by folding up both hydraulic wings to better transport from one field to another, and to store the cutter in tight spaces.

## Features & Options

- 15' dual wing rotary cutter
- 4 heavy duty gearboxes, each covered with 7 Year limited warranty
- Transport lock for each wing
- 1.5" diameter cutting capacity
- Each wing can float to conform to ground contours



Model	PW180
Shipping Weight (LBS.)	4,400
3PH Mount	Draw Bar Hitch
Cutting Height	3"-15"
Cutting Path	180"
Max Brush Diameter	1.5"
Overall Width (Wings Down)	184"
Folded Width (Wings Up)	78"
Tip Speed (Ft/Min)	15,100 ft/min on Wings 14,850 ft/min on center
Wheels (Pneumatic)	21"
Blades	9 blades 1/2"x4"
Tractor HP (min)	75HP
PTO RPM	540
Gearbox Rating (Wing)	140 HP
Gearbox Rating (Center)	105 HP
Gearbox Rating (Divider)	87 HP
Deck	3/16"
Stump Jumper	Yes
Protection	Independent Slip Clutch on Each Spindle
Wing Float Range(degrees)	22 down and 33 up

# Finishing Mowers



The MK Martin Finishing Mower is available for a wide variety of lawn mowing applications. Available in four sizes, there is a size to fit your mowing needs. Riding on four solid rubber tires, the Finishing Mower floats smoothly over your lawn without worry of flat tires. A floating top link ensures that all four wheels keep contact with the ground as your 3PH equipped tractor pulls it along.

Model	PFM48RD	PFM60RD	PFM72RD	PFM90RD
<b>Cutting Width</b>	48"	60"	72"	90"
<b>Overall Width</b>	50"	62"	74"	93"
<b>Weight (LBS.)</b>	370	435	525	714
<b>Acres/Hr@5 MPH</b>	2.43	3.03	3.63	4.57
<b>HP Required</b>	14/20	20/25	25/30	30/40
<b>3PH Mount</b>	CAT. 1	CAT. 1	CAT. 1	CAT. 1
<b>RPM @ PTO Shaft</b>	540	540	540	540
<b>Number of Blades</b>	3	3	3	5
<b>Tip Speed (Ft/Min)</b>	15,660	18,000	16,850	16,288
<b>Wheels</b>	Solid Rubber Wheel	Solid Rubber Wheel	Solid Rubber Wheel	Solid
<b>Deck Thickness</b>	10 GA	10 GA	3/16"	3/16"
<b>Cutting Height</b>	2" - 5"	2" - 5"	2" - 5"	2" - 5"

*The Pulsar Rotary Cutter is backed by a 7 Year Limited Warranty.*





## Features

- 7 year limited warranty
- Cat. 1 hitch
- 4 Solid rubber tires
- Floating end link
- Taper lock pulleys



**Blade Assembly**



**Floating Top Link**



**Solid Rubber Wheel**



**Adjustable Height**



**Rear Discharge Shield**



**Optional Chain Guard**

# Trail/UTV Mower



UTVM48

## Remote e-Stop

Cabled e-Stop can be placed on tow vehicle for easy reach. (UTVM48 Only)



## Features

- 44" - 48" Cutting Width
- Briggs & Stratton Engines
- 12 Volt electric start (UTVM48 Only)
- Remote e-Stop (UTVM48 Only)
- 2 Rotors with 3 blades each
- Adjustable cutting height (2" - 7") with ratchet style adjustment
- 3 position hitch for straight or offset cutting
- Flat free tires
- Swivel wheels on front, fixed wheels on rear (UTVM48 Only)





**NEW**  
PRODUCT

Tame your property using the MK Martin UTV mowers. Both UTV mower models are self-powered with reliable Briggs & Stratton engines, giving you the power you need to run without needing a PTO or hydraulic hookup.

The mowers are equipped with two 3-blade rotors, cutting through tall grass and weeds without a problem. Flat free tires help maintain consistent travel height and prevent downtime from blowouts when working in rough areas.



UTVM48E

Model	UTVM48	UTVM48E
<b>Engine Brand</b>	Briggs & Stratton	Briggs & Stratton
<b>Engine</b>	19 HP	2 Engines (190 CC each)
<b>Starting System</b>	Key (electric)	Pull start
<b>Fuel Tank</b>	3 Gal.	1 Gal.
<b>Battery</b>	12 Volt	N/A
<b>Deck</b>	Rear Discharge	Rear Discharge
<b>Deck Thickness</b>	10 ga	10 ga
<b>Blade Assembly</b>	2 Rotors with 3 Blades each	2 Rotors with 3 Blades each
<b>Cut Width</b>	44"	48"
<b>Cut Height</b>	2" - 7"	2" - 6"
<b>Max Brush Diameter</b>	3/4"	1/2"
<b>Wheels</b>	14 x 6	2 1/2 X 12"
<b>Weight</b>	720 lbs	325 lbs

# Lawn Sweepers



Sweep up debris from your lawn with the new Lawn Sweeper from MK Martin. With a 21 cu.ft. hopper capacity, durable mesh netting, and a 46" wide broom, it takes fewer trips to get the job done. The poly bristle broom is gentle on your lawn and tough on debris. The handle on the side of the hopper and pivoting net frame allows for quick and easy dumping letting you finish the job even faster.

Model	MKLS1846
Sweeping Width	46"
Overall Width	65"
Length	95"
Motor (HP)	6.5 HP Vanguard Engine
Brush Diameter	18"
Drive System	Chain - Fully Engaged so the brush turns all the time
Broom Lift	12V Electric
Hopper Capacity	21 Cu.Ft.
Wheels	13x5.00-6 NHS Flat Free Tires
Weight (LBS.)	515



## Features

- Electrically Controlled Poly Broom with Remote
- Leaf Bucket with Pivot for Easy Emptying
- Replaceable Durable Mesh Netting
- Flat Free Tires
- 6.5 HP Vanguard Engine



## Height Adjustment

Height Adjustment is controlled with a switch box with a magnetic base for easy mounting to your tow unit.

# Axis Tool Arm



The Axis Tool Arm has been developed to provide an economical alternative for mowing road side ditches or along side fences. Offset design allows plenty of room to clear the tractor tires, as well as keeping the tractor on a more level surface. Should you hit a solid object with the outer edge of the tool attached to the arm, the Axis Tool Arm is equipped with shear bolt protection on a breakaway link. With a 55° cutting angle with the cylinder extended, and 90° cutting angle with the cylinder retracted, the operator has ample flexibility to match whatever terrain they are working with.



## Hydraulic Tool Lift

The Axis Tool Arm hydraulically pivots on your 3PH raising and lowering the tool as needed. With the Axis fully raised the mower can be folded in to provide safe road travel.



## Hydraulic Tool Rotation

To provide the best results when mowing along ditches or around ponds, the tool carrier is hydraulically adjustable allowing mower adjustments to match the terrain grade.



## Transport Lock



## Retractable Weight Bar



Model	AXIS4	AXIS5-6
Weight (LBS.)	751	900
Offset	60"	84"
3PH Mount	CAT. 1	CAT. 1 & 2
Minimum Tractor Weight (LBS.)	2,900	5,800
Maximum Tool Weight (LBS.)	480	800
4' Rotary Cutter (Not Included)	req. min. 30 HP	
5' Rotary Cutter (Not Included)	req. min. 60 HP	
6' Rotary Cutter (Not Included)	req. min. 80 HP	
Cutting Angle Cyl. Ext.	55°	
Cutting Angle Cyl. Ret.	90°	
Tractor Remotes Req.	2	
Protection	Shear Bolt	Shear Bolt

## Stabalizer Arm to Cutter

Various attachment bracket are supplied with the Axis Toolbar to attach the Stabilizer Bar to the cutter. All four adaptors are included.

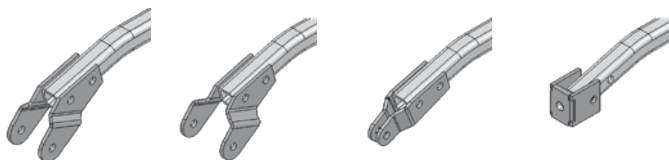

**Shown in order:** Pulsar, Kodiak, Fork Rear Wheel Style with 180° Wheel Adjuster, Fork Rear Wheel Style with Flat Wheel Adjuster

# 3PH Box Blades



The 3PH Box Scraper designed by MK Martin provides owners of small and large properties affordable options for land grading. Complete with steel cutting edges, height adjustable shanks, quick hitch compatibility, and a fully welded 3PH design, these Box Scrapers deliver impressive results.

The MK Box Scraper features two steel cutting edges. One is located on the inside of the box and the second is on the outside. These two reversible hardened steel cutting edges allow the operator to pull or push material.

## Height Adjustable & Replaceable Scarifier Tips

The height adjustable ripper shanks break up the soil allowing the cutting edge to redistribute the material as the box scraper is pulled along. Removeable shanks feature replaceable scarifier tips.

Model	Width	Shanks	Mouldboard	End Plates	3PH Mount	Max HP	Weight (LBS.)
<b>448 STD</b>	4'	3	3/16"	1/4"	CAT. 1	35 HP	308
<b>560 STD</b>	5'	3	3/16"	1/4"	CAT. 1	35 HP	348
<b>566 HD</b>	5'6"	4	3/16"	1/4"	CAT. 1	45 HP	415
<b>672 HD</b>	6'	5	3/16"	1/4"	CAT. 1	45 HP	450
<b>784 HD</b>	7'	6	3/16"	1/4"	CAT. 1	45 HP	500
<b>784 DLX</b>	7'	6	1/4"	1/4"	CAT. 2	75 HP	555
<b>896 DLX</b>	8'	7	1/4"	1/4"	CAT. 2	75 HP	612





Groom your track or arena surface with the MK Martin Track-Curry. This easy to use tool will allow conditioning of track surfaces to your desired firmness. With two rows of heavy duty S-tines to cultivate the ground, an adjustable leveling bar fastened to the rear of the S-tines, and a 12" rolling drum behind the leveling bar, the Track-Curry provides an accurate depth gauge to cultivate and pack your soil for optimum performance. The MK Martin Track-Curry will condition your arena or track to the footing most suited for the health and safety of your horses.



**Spill Plates**



**Optional Wing**



**Scarifier Bar**



**Sprinkler Kit**

Model	TC-5	TC-6	TC-7	TC-8
Working Width	5'	6'	7'	8'
Number of Shanks	13	15	17	19
Shank Size	1-1/4" x 3/8" x 22"			
Shank Clearance	16"	16"	16"	16"
3PH Mount	CAT. 1	CAT. 1	CAT. 1	CAT. 1
HP Rating	18 - 32	22 - 39	26 - 47	30 - 53
Weight (LBS.)	460	530	640	725
Leveling Bar	1/2" x 6" (double beveled)			

# Grader Blades



*Shown with optional Hydraulic Angle blade*

## Features

- 1/2" x 6" reversible cutting edge
- Full turn around with five locations forward and reverse on manual only
- 3/8" mouldboard - 98 series
- Hydraulic Angle (optional)
- Quick hitch compatible

The 3PH Grader Blade from MK Martin makes maintaining your driveway and gravel areas easy. Ruggedly built with a reversible cutting edge, these blades are designed for years of service.

The Manual Blades have five stops of angle adjustment including a full turn around, while the optional Hydraulic Angle blades allow control of the blade from the comfort of your seat. With widths to match your equipment and property, there is an MK Scraper blade to help keep your grades up.

Model	Max. HP	Width	Mouldboard	Mouldboard Height	Center Pin	3PH Mount	Weight (LBS.)
MKGB588	45	5'	3/16"	15"	2"	CAT. 1	180
MKGB688	45	6'	1/4"	15"	2"	CAT. 1	200
MKGB788	45	7'	1/4"	15"	2"	CAT. 1	215
MKGB798	75	7'	3/8"	15"	3"	CAT. 2	577
MKGB898	75	8'	3/8"	15"	3"	CAT. 2	616



MKGN467 shown

## Features

- Five Stops of angle adjustment (Forward and back)
- Manual angle adjustment
- 3/16" Mouldboard
- 3/8" x 6" reversible cutting edge
- Quick hitch compatible

Model	MKGB467	MKGB567	MKGB667
<b>Horsepower</b>	30 HP	30 HP	30 HP
<b>Hitch</b>		CAT. 1	
<b>Width (in.)</b>	48"	60"	72"
<b>Weight (lbs.)</b>	140	149	155
<b>Reverse</b>		Yes	
<b>Mouldboard</b>		3/16" Material	
<b>Mouldboard Height</b>	15"	15"	15"
<b>Cutting Edge</b>		3/8" x 6" Reversible	
<b>Angle (Control)</b>		Yes (Manual)	
<b>Angle (Position)</b>		5 Stops Forward / 5 Stops Reversed	

# Offset Tilt Grader Blades

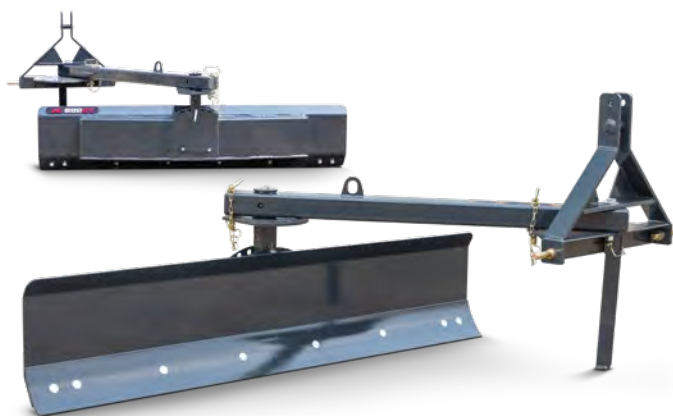

## Features

- Angle Manual Adjustment
- Offset Manual Adjustment
- Tilt Manual Adjustment
- 180° Reversible
- Bolt-On Cutting Edge
- Park Stand
- Rubber Cutting Edge

Available in 5, 6, and 7 foot widths, this versatile grader blade is designed for tractors equipped with Cat 1 3PH. This grader blade features offset, tilt, and angle adjustments each with 5 positions allowing it to tackle any job you can throw at it. The blade is also able to reverse 180° allowing you to grade your property while backing up for even more options.

Model	MK5880T	MK6880T	MK7880T
<b>HP</b>	30 - 50	30 - 50	30 - 50
<b>Hitch</b>	Cat. 1	Cat. 1	Cat. 1
<b>Width</b>	60"	72"	84"
<b>Weight (LBS.)</b>	250	258	270
<b>Reverse</b>	Yes	Yes	Yes
<b>Mouldboard</b>	1/4"	1/4"	1/4"
<b>Mouldboard Height</b>	15"	15"	15"
<b>Cutting Edge</b>	3/8 x 6 Reversible		
<b>Angle (Control)</b>	Manual	Manual	Manual
<b>Angle (Position)</b>	5 Forward / 5 Reversed		
<b>Offset Adjust</b>	5 Positions	5 Positions	5 Positions
<b>Tilt Adjust</b>	5 Positions	5 Positions	5 Positions



## Extreme Duty Grader Blade for 100-150 HP Tractors

The Extreme Duty Grader Blade from MK Martin mounts to your 3-point tractor hitch. Powered by the hydraulics of your tractor, the XD series blade has hydraulic cylinders to adjust the offset of the arm, blade angle, and tilt of the blade. An additional hydraulic cylinder on the optional wheel kit helps with depth control. The Extreme Duty grader blade is available in 8', 9' and 10' models for tractors with a rated horsepower of 100 and 150 HP. Available options include dual gauge wheel kit with hydraulic cylinder.

Model	8XD-100	9XD-100	9XD-150	10XD-150
Horse Power (Max.)	100	100	150	150
3PH Mount	CAT. 2 & 3			
Mouldboard Thickness	5/16"			
Mouldboard Width	96"	108"	108"	120"
Mouldboard Height	20"			
Offset Adjustment	27" left or right (hydraulic)			
Adjustment Angle	32° left or right (hydraulic)			
Adjustment Tilt	13° blade adjustment (hydraulic)			
King Pin	3-1/2"	3-1/2"	4"	4"
Cutting Edge	High Carbon 1/2" x 6" (reversible)			
Weight (LBS.)	1,572	1,666	1,695	1,745

### Features



Hydraulic Angle



Hydraulic Tilt



Hydraulic Offset

# Grader Levelers



This two-in-one combination of leveling and scraping makes short work of your grading jobs. The first blade attacks the high spots cutting them down to size and the second blade further scrapes anything the first missed and fills in the hollows. With two blades cutting and filling it takes much less time and fewer passes to achieve the even distribution of material you are looking for.

The scraper can be 3PH mounted, or equipped with a skidsteer adapter plate to keep the work in front of you.



Top View

Model	GL578	GL678	GL778	GL878
<b>Working Width</b>	60"	72"	84"	96"
<b>Overall Width</b>	65"	77"	89"	101"
<b>Skid Shoes</b>	3/8" x 2 Reversible	3/8" x 2 Reversible	3/8" x 2 Reversible	3/8" x 2 Reversible
<b>Mouldboard Thickness</b>	1/4"	1/4"	1/4"	1/4"
<b>Cutting Edge</b>	1" Adjustment	1" Adjustment	1" Adjustment	1" Adjustment
<b>Weight (LBS.)</b>	600	665	730	796



Top View



## Features & Options

- Two angled 1/2" x 6" Reversible Cutting Edges
- Cutting Edge Angled between 5° - 9° depending on model
- 3/8" x 2 Reversible Skid Shoes
- Cutting edges can be manually adjusted to your desired cutting depth for optimal performance
- Order Mount separately (3PH or Skidsteer Adaptor)

Model	GL578A	GL678A	GL778A	GL878A
<b>Working Width</b>	60"	72"	84"	96"
<b>Overall Width</b>	65"	77"	89"	101"
<b>Skid Shoes</b>	3/8" x 2 Reversible	3/8" x 2 Reversible	3/8" x 2 Reversible	3/8" x 2 Reversible
<b>Mouldboard Thickness</b>	1/4"	1/4"	1/4"	1/4"
<b>Cutting Edge</b>	1" to -0.5"	1" to -0.5"	1" to -0.5"	1" to -0.5"
<b>Cutting Angle (Deg.)</b>	9	7	6	5
<b>Weight (LBS.)</b>	568	632	697	761



# Land Planes



Designed to revive your laneway or gravel lots, the Land Plane provides acreage owners with a single tool to tear up hardpack, fill potholes, and grade for a smooth, desirable finish.

Two hydraulic cylinders power the scarifier bar deep below the surface, loosening the hard pan and pulling the material to the surface where it can be redistributed. The hydraulic control allows the operator to adjust pressure on-the-fly to compensate for the changing ground conditions without having to leave the operator's seat.



The Land Plane is available in either skid loader or 3PH mounts.



Model	LP678	LP778	LP878
<b>Working Width</b>	72"	84"	96"
<b>Overall Width</b>	77"	89"	101"
<b>Length</b>	69.5"	69.5"	69.5"
<b>Shank (Qty.)</b>	6	7	8
<b>Shank Tube</b>	4" x 6" x 1/4"		
<b>Cutting Edge (x2)</b>	Hardened 1/2" - Reversible 1" Adjustments		
<b>Skid Shoes</b>	3/8" x 2 Reversible		
<b>Cylinder</b>	Dual Hydraulic Cylinders for shank rotation		
<b>Weight (LBS.)</b>	1,140	1,240	1,350



## LAND LEVELER



These rugged scrapers come in a range of sizes from 8'-12' to fit your needs and equipment. Standard on all models is our 1/2" thick reversible hardened cutting edge, ready to smooth out the bumps and fill in the hollows. Cutting depth is controlled by a 3"x12" hydraulic cylinder so you can decide how much of a bite to take and adjust on the go. All models are well suited for feedlot and soil reclamation or swale cutting.

Trailed Models	LLT-8	LLT-10	LLT-12
<b>Width</b>	8'	10'	12'
<b>Mount</b>	Hitch	Hitch	Hitch
<b>Horse Power (Max.)</b>	165	165	165
<b>Tilt</b>	Yes	Yes	Yes
<b>Cutting Edge</b>	Single	Single	Single
<b>Side Plate</b>	3/8"	3/8"	3/8"
<b>Mouldboard</b>	1/4"	1/4"	1/4"
<b>Wear Plate</b>	NA	NA	NA
<b>Skidbar</b>	1/2" Reversible	1/2" Reversible	1/2" Reversible
<b>Weight</b>	1,555	1,771	1,898



3PH Model	LLP-8	LLP-10	LLP-12	LLP2-8	LLP2-10	LLP2-12
<b>Width</b>	8'	10'	12'	8'	10'	12'
<b>Mount</b>	3PH	3PH	3PH	3PH	3PH	3PH
<b>Horse Power (Max.)</b>	165	165	165	165	165	165
<b>Tilt</b>	NA	NA	NA	NA	NA	NA
<b>Cutting Edge</b>	Single			Double		
<b>Side Plate</b>	3/8"	3/8"	3/8"	3/8"	3/8"	3/8"
<b>Mouldboard</b>	1/4"	1/4"	1/4"	1/4"	1/4"	1/4"
<b>Wear Plate</b>	3/4"	3/4"	3/4"	3/4"	3/4"	3/4"
<b>Skidbar</b>	NA	NA	NA	NA	NA	NA
<b>Weight</b>	838	956	1,077	945	1,090	1,238

# 3PH Rotary Tillers



## Features & Options

- Replaceable Bolt-On Tines
- Self Lubricating Chain Drive
- Adjustable Skidshoes
- Floating Deflector
- Gear Box
- 3PH Mount Offset
- Slip Clutch

Models	RT486	RT546	RT606	RT726
<b>Horsepower</b>	15-30 HP	20-40 HP	20-50 HP	25-60 HP
<b>Hitch</b>	CAT. 1	CAT. 1	CAT. 1	CAT. 1
<b>Inner Width (in.)</b>	50	54	58	74
<b>Overall Width (in.)</b>	55.375	59.375	63.375	79.375
<b>Weight (lbs.)</b>	491	514	525	636
<b>Number of Flanges</b>	6	6	7	9
<b>Tines/Flange</b>	6 (C-Shape)	6 (C-Shape)	6 (C-Shape)	6 (C-Shape)
<b>Flange Spacing (in.)</b>	7.75	7.75	7.75	7.75
<b>Max Tillage Depth (in.)</b>	6.5	6.5	6.5	6.5
<b>Number of Skid Shoe Settings</b>	5	5	5	5
<b>Rotor Diameter (in.)</b>	17"	17"	17"	17"
<b>Rotor Speed @ 540 PTO (RPM)</b>	211	211	211	211
<b>Gearbox (HP)</b>	50HP @ 540	50HP @ 540	50HP @ 540	50HP @ 540
<b>Drive Chain</b>	#80	#80	#80	#80



Prepare your seedbed or garden for planting using the MK Martin Rotary Tiller. With standard features such as adjustable skidshoes, floating deflector, replaceable tines, and an oil bath drive chain, this tiller easily loosens soil for a variety of applications.

Available in a range of sizes, there's an MK Rotary Tiller for any application.

Models	RT726H
<b>Horsepower</b>	NA
<b>Hitch</b>	Skid steer attachment plate
<b>Inner Width (in.)</b>	74
<b>Overall Width (in.)</b>	79.375
<b>Weight (lbs.)</b>	575
<b>Number of Flanges</b>	9
<b>Tines/Flange</b>	6 (C-Shape)
<b>Flange Spacing (in.)</b>	7.75
<b>Max Tillage Depth (in.)</b>	6.5
<b>Number of Skid Shoe Settings</b>	NA
<b>Rotor Diameter (in.)</b>	17"
<b>Rotor Speed @ 540 PTO (RPM)</b>	NA
<b>Gearbox (HP)</b>	NA
<b>Drive Chain</b>	#80

# Cultivator

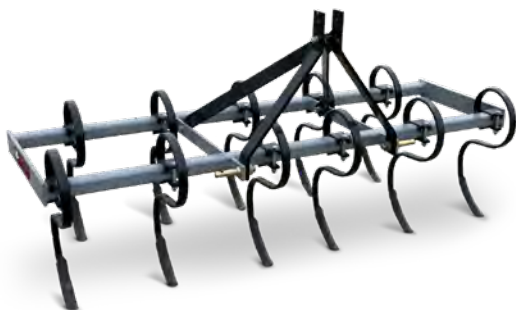

This line of economy cultivators is ideal for cultivating small fields and gardens.

Model	CU-5	CU-6	CU-7
Working Width	60"	72"	84"
Overall Width	60-1/2"	72-1/2"	84-1/2"
Weight (LBS.)	164	193	222
Tines (Heat Treated)	9 tines	11 tines	13 tines
3PH Mount	CAT. 1	CAT. 1	CAT. 1

## Landscape Rake

### Features

- 5 forward and 3 reverse positions with manual adjustment
- 5/16" x 1" x 15.25" spring tines
- CAT. 1 Quick Tach compatible



Model	MKLR5	MKLR6	MKLR7
Width	5'	6'	7'
MAX HP	50	50	50
Weight (LBS.)	250	263	285
Tines	30	36	42



## Features

- Shanks & sweeps keep soil loose after tractor compaction
- Adjustable disc height and horizontal spacing
- Discs angle is adjustable
- 2x2 steel tube construction



<b>Model</b>	<b>GH60</b>
<b>Width</b>	60"
<b>Hitch</b>	CAT. 1
<b>Disc</b>	14"
<b>Weight</b>	100 lbs.



# 3PH Weight Boxes



With an internal material holding volume of 3.5 cubic feet and maximum holding weight capacity of 525 lbs, this weight box can add up to 575 lbs of balancing weight to your CAT. 1 3PH. This added weight backs up your tractor by offsetting your loader mounted attachments, helping to keep your tractor safely balanced during operation. This weight box has a tool holder, clean out hatch, and a 2" hitch receiver.

Specifications	MKWB
Hitch Type	CAT. 1
Box Volume	3-1/2 cu ft
Max Weight (box and fill) (LBS.)	575
Max Weight (fill only) (LBS.)	525
Quick Hitch Compatible	Yes
Shipping Weight (LBS.)	104

Fill Type	Weight Per Cubic Foot (lbs.)
Concrete	150
Gravel	110
Sand	100







This general purpose 3PH Utility Dump Box comes in two sizes for the home owner, landscaper or wood lot owner.

- 3PH hookup CAT. 1
- Quick and easy dump
- Raise and lower to desired height for loading
- Heavy duty tubular sub frame
- 14 GA. material box structure

Model	Cap	Size	Weight (LBS.)
<b>DB495</b>	30 cu ft	18" x 48" x 48"	290
<b>DB395</b>	10 cu ft	10" x 36" x 36"	120



# Gravity Boxes



## Standard Features

- Viewing Windows
- LED Road Lights
- Front Ladder
- Unloading Door includes metering door
- Solid Welded Box Interior

Model	MK 3200		
Extension	N/A	8"	19"
Capacity (Bushels)	320	375	450
Hopper Construction	14 GA.		
Under Structure	3" x 6" x .188 wall rectangular tube		
Unloading Door	45" width		
Chute Height	17"-20"		
Box Dimensions			
Length	158"	158"	158"
Width	96"	96"	96"
Height (less wagon)	78"	86"	98"
Height (wagon & 22.5" wheel)	102"	110"	122"
Wheel Base	112"		



## Optional Equipment

- Horst Running Gear
- Center Dump Deflector
- Divider Kit
- Grain Shield Tarp Kit
- Hydraulic Door Opener
- Rear Ladder Kit

MK 5000			MK 6500		
N/A	8"	12"	N/A	8"	12"
500	570	605	645	745	800
12 GA.			12 GA.		
4" x 8"			4" x 8"		
.188" wall rectangular tubing			.188" wall rectangular tubing		
57" width (standard) 28" width x2 (divider)			57" width (standard) 28" width x2 (divider)		
17"-21"			16"-20"		
196"	196"	196"	229"	229"	229"
101"	101"	101"	115"	115"	115"
89"	98"	101"	91"	99"	103"
123"	131"	135"	125"	133"	137"
	142"			156"	

# 1200 Gravity Box



Model	MKGW12000
Extension	N/A
Capacity (Bushels)	1,200
Hopper Construction	12 GA.
Under Structure	4x8x.25w
Unloading Door	15" length x 47" width X 2
Chute Height	18"
Box Dimensions	
Length	315"
Width	110"
Height (less wagon)	136"
Height (wagon & 22.5" wheel)	156"
Wheel Base	215"



## Hydraulic Door Opener

Part # MKGW-HYD Door	Description
<b>MKGW50HD</b>	Hydraulic Door Opener (MK5000)
<b>MKGW65HD</b>	Hydraulic Door Opener (MK6500)



The Hydraulic Door allows you to conveniently control the metering of the material using a remote from your tractor.

## Divider Kit

Part #	Description
<b>MKGW32DIV</b>	Center Divider (MK3200)
<b>MKGW50DIV</b>	Center Divider (MK5000)
<b>MKGW65DIV</b>	Center Divider (MK6500)

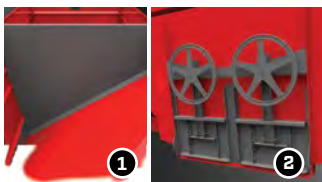

The optional divider splits your Gravity Box **1**, allowing for two separate commodities to be in the box at the same time. Each side also has it's own door for individual unloading and metering **2**.

## Grain Shield Tarp Kit

Part #	Capacity
<b>MKGW32TS</b>	320-450
<b>MKGW50TS</b>	500-610
<b>MKGW65TS</b>	645-800
<b>MKGW120TS</b>	1200



## Rear Ladder Kit

Part #	Description
<b>MKGW32LAD</b>	Fits 3200 Models
<b>MKGW50LAD</b>	Fits 5000 & 6500 Models



## Center Dump

Part #	Description
<b>MKGW65CD</b>	Center Dump for 5000 & 6500



# Stack N Fold Toolbar



The Stack N Fold Toolbar from MK Martin is designed to provide safe and easy transport of Strip Cat strip till systems. By stacking both end sections over the center section, the Stack N Fold Toolbar quickly reduces the overall width providing easier transport from field to field. The over centre design and locking pins ensure that the end sections remain securely in place during travel and when in storage.

Stack N Fold Toolbars can be configured with 2 to 4 remotes allowing you to control each side of the toolbar separately. This allows for easier service and maintenance, as well as for custom operations when you may not need the full width of the Strip Cat, such as on headlands and point rows.

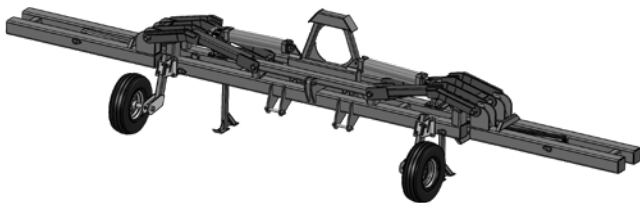

## Features

- Available from 8-Row to 18-Row
- Allows for parallel horizontal stacking of row units
- Ideal for transport and storage
- Equipped with 2 large cylinders (5x30 fold cyl.)
- Equipped with 2 small cylinders (2x4)
- Requires 2 to 4 remotes depending on configuration



The MK Disc Mower Implement Caddy transforms your 3PH disc mower into a pull-type unit to help reduce wear on the mower while reducing stress from your tractor. Using the adjustable top link, you can connect your disc mower faster and easier than before. With the addition of the adjustable hitch, you can level your caddy and mower for an even cut as you drive along.

The MK Disc Mower Implement Caddy comes in two models: inline (C1201) and offset (C1200).

Model	MKC1200	MKC1201
<b>Weight (LBS.)</b>	1,900	1,835
<b>Max Implement Weight</b>	1,400 lbs.	1,400 lbs.
<b>Lift Cyl.</b>	3x8	3x8
<b>Tires</b>	11L 15	11L 15
<b>Main Frame</b>	7x7 Tube	7x7 Tube
<b>RPM</b>	540	540
<b>Driveline</b>	#5	#5

## Features



**Adjustable Hitch**



**Hydraulic (Option)**



# Implement Caddy



## Features

- 12,000 LBS. capacity
- 3PH Mount Cat. 2 or 3 implements
- Hydraulically raise and lower caddy to desired height

The Implement Caddy by MK Martin converts your 3PH implements to trailed versions when access to a 3PH equipped unit is not available. Hydraulically raise and lower caddy to desired height. This alternative to conventional 3PH mounting allows greater flexibility over your work force.

Model	SCIC250	SCIC1700
Width	125"	152"
MAX HP	250	500
Weight (LBS.)	3,560**	7,750
Lift Cyl.	3-1/2 x 16	5 x 14
Lift Capacity (LBS.)	12,000	20,000
Category	CAT. 2 & 3	CAT. 4
Tires	12.5L	16.5 x 16.1

*\*\*Includes the weight of the weight box*





## Features

- Gandy 10 cubic feet Orbit Air Skidsteer Adaptor) seed applicator
- Two angled 1/2" x 6" Reversible Cutting Edges
- Cutting Edge Angled between 5° - 9° depending on model
- 3/8" x 2 Reversible Skid Shoes
- Cutting edges can be manually adjusted to your desired cutting depth for optimal performance
- Order Mount separately (3PH or Skidsteer Adaptor) seed applicator
- Multiple species seed capability
- 11 row 27 1/2' width
- 15 row 37 1/2' width
- Category II and III w/quick hitch compatibility
- Independent row units
- 30" row width
- Parking stands

Inter Seeder rolling tines create some soil disturbance, improving the seed to soil contact. This improves the germination compared to seeds that are just broadcasted.



Model	11 Row	15 Row
Width	27.5"	37.5"
Weight (LBS.)	N/A	N/A
Category	CAT II & III	CAT II & III



**LIVING  
COUNTRY**

**7  
YEAR  
WARRANTY**

**M** **MKMARTIN**  
ENTERPRISE Inc.

3950 Steffler Rd., Elmira, Ontario, N3B 2Z3

Toll Free: 855-664-2752  
Tel: 519-664-2752  
Email: sales@mkmartin.ca

[www.mkmartin.ca](http://www.mkmartin.ca)

**Authorized Dealer**

