



# **BAUMALIGHT™**

## **STUMP BLASTER S24 and S28**

### **OPERATOR'S MANUAL**

**THE RIGHT  
EQUIPMENT**

D001654

Issue Date 15 Aug 12

# TABLE OF CONTENTS

SECTION	DESCRIPTION	PAGE
1	Introduction . . . . .	1
1.1	Overview . . . . .	1
1.2	Intended Use and Foreseeable Misuse . . . . .	2
2	Safety . . . . .	3
2.1	Safety Alert Symbol and Safety Words . . . . .	3
2.2	Operational Hazards . . . . .	4
2.3	Maintenance Hazards . . . . .	8
3	Safety Signs . . . . .	10
4	Assembly . . . . .	12
4.1	Remove Shipping Dunnage and Parts . . . . .	12
4.2	Remove Stump Grinder From Pallet . . . . .	13
5	Operation . . . . .	14
5.1	Preparation for Use . . . . .	14
5.2	Pre-Operation Check List . . . . .	15
5.3	Machine Components . . . . .	16
5.4	Attaching Stump Grinder to Skid Steer . . . . .	17
5.5	Detaching Stump Grinder Skid Steer . . . . .	18
5.6	Transporting . . . . .	19
5.7	Carbide Teeth Break-In . . . . .	19
5.8	First Time User Tips . . . . .	20
5.9	Field Operation . . . . .	21
6	Service and Maintenance . . . . .	24
6.1	Service . . . . .	24
6.1.1	Replace Cutting Teeth . . . . .	25
6.1.2	Replace Spyder . . . . .	26
6.1.3	Replace Hydraulic Hoses . . . . .	27
6.2	Maintenance . . . . .	28
6.2.1	Every 6 Hours . . . . .	29
6.2.2	Every 10 Hours . . . . .	30
7	Troubleshooting . . . . .	31
8	Storage . . . . .	32
8.1	Storing Grinder (End of Season) . . . . .	32
8.2	Removing Grinder from Storage . . . . .	32
9	Specifications . . . . .	33
10	Warranty . . . . .	34

# 1 INTRODUCTION

## 1.1 Overview

Congratulations on your choice of a Baumalight Skid Steer Stump Grinder to complement your stump grinding operation. This equipment has been designed and manufactured to meet the needs of a discriminating buyer for efficient grinding of stumps.

The S24 and S28 have 34 teeth on a 24" cutter. This means less cutting for each tooth resulting in longer tooth life and smoother cutting for less wear on the skid steer. Heavy tooth population makes finer mulch and smoother operation.

The cutting wheel is powered by the hydraulics on your skid steer with the swing cylinders activated by the standard remote hydraulic connectors on the skid steer.

Grease zerks and replaceable bushings are provided at major pivot points for extended service life.

The debris shields is standard equipment on all stump grinders. It is recommended that the stump grinder never be operated without one.

Safe, efficient and trouble free operation of your Stump Grinder requires that you and anyone else who will be operating or maintaining the Stump Grinder, read and understand the Safety, Operation, Maintenance and Troubleshooting information contained within the Operator's Manual.

This manual covers the Baumalight Skid Steer Stump Grinder, models S24 and S28. Use the Table of Contents as a guide to locate required information.

Keep this manual handy for frequent reference and to pass on to new operators or owners. Call your Baumalight dealer, distributor or the factory if you need assistance, information or additional copies of the manuals.

When this machine is worn out and no longer in use, it should be returned to the retailer or other party for recycling.

**OPERATOR ORIENTATION** - The directions left, right, front and rear, as mentioned throughout this manual, are as seen from the skid steer driver's seat and facing in the direction of travel.

## **1.2 Intended Use and Foreseeable Misuse**

The Stumpblaster stump grinding tool is designed to be used on site to remove softwood and hardwood tree stumps by reducing the stumps to chips and dust. The stump grinding tool is designed to be used by experienced operators, trained in the safe operation of a skid steer and trained in the hazards related to using the stump grinder and the safe use of the grinder for the intended purpose. Operators will require personal protective equipment to reduce the risk from some hazards that cannot be completely eliminated or controlled by the design of the tool.

Each model in the family is intended to be used within the stump size limits shown in the catalog and in the implement specifications in the manual.

Care is required to ensure that the stump grinding tool will not come across metallic objects, stones or other materials harder than a typical stump while grinding.

The Stumpblaster stump grinding tools are not designed for use in hazardous atmospheres where there is a risk of fire or explosion due to flammable gases or vapours. Use in hazardous, explosive atmospheres is prohibited.

Serious injury or death of the operator or bystanders may be caused if the tool is misused. Misuse may also cause damage to the skid steer carrying the implement.

## 2 SAFETY

### 2.1 Safety Alert Symbol and Safety Words

You must read, understand and follow the instructions given by the operating unit manufacturers, as well as the instructions in this manual.

The safety information in this manual is denoted by the safety alert symbol:



This symbol means ATTENTION! BECOME ALERT! YOUR SAFETY IS INVOLVED!

The level of risk is indicated by the following signal words:



#### **DANGER**

**DANGER** - Indicates a hazardous situation, which, if not avoided, **WILL** result in death or serious injury.



#### **WARNING**

**WARNING** - Indicates a hazardous situation, which, if not avoided, could result in death or serious injury.



#### **CAUTION**

**CAUTION** - Indicates a hazardous situation, which, if not avoided, could result in minor or moderate injury.

#### **NOTICE**

**NOTICE** - Indicates a situation that could result in damage to the equipment or other property.

## 2.2 Operational Hazards



### WARNING

**Prevent serious injury or death.**

**Read and understand this manual before operating stump grinder.**

**Always stop engine and remove key before leaving operators seat.**

**Never allow anyone near the stump grinder during operation.**

**Travel at a safe speed.**



### WARNING

**Prevent serious injury or death from moving parts.**

**Moving parts can crush and dismember.**

**Do not operate without guards and shields in place.**

**Disconnect and lock out power source before adjusting or servicing.**



### WARNING

**Use stump grinder only for the designed applications.**

**Any other use may result in personal injury, damage to equipment and may void the warranty.**



### WARNING

**Prevent serious injury or death.**

**Verify stump grinder is attached to skid steer before operation or transport.**

Carefully read all safety messages in this manual and on equipment safety signs. Keep safety signs in good condition and replace missing or damaged safety signs.

New equipment components and repair parts must include the current safety decal.

Learn how to properly operate equipment. NEVER operate or work around this equipment without proper instruction, while fatigued or under the influence of alcohol, prescription or non-prescription medication or if feeling ill.

Keep your equipment in proper working condition.

Know the regulations and laws that apply to you and your industry. This manual is not to replace any regulations or laws. Additional information may be found at: [www.asae.org](http://www.asae.org) or [www.osha.gov](http://www.osha.gov).

If you do not understand any part of this manual, contact Baumalight at 866-820-7603.

## Prepare for Emergencies

- Be prepared in case of emergencies.
- Keep a fire extinguisher and first aid kit close to the machine.
- Keep emergency phone numbers close to your phone.
- Know your address so emergency services can locate you if an emergency arises.

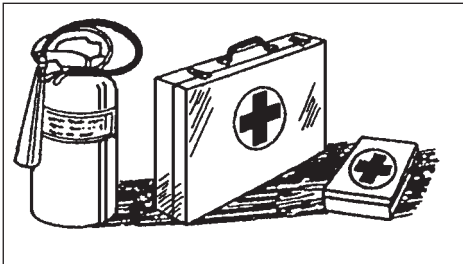

## Replace Safety Signs

- Replace missing or damaged safety signs.
- Safety signs are identified in Section 3 of this manual.
- Replacement safety signs are available from your Baumalight dealer.

## Do Not Allow Riders

- NEVER lift or carry anyone with stump grinder.
- NEVER use stump grinder as a work platform.
- NEVER allow passengers on stump grinder.

## Lower Operating Speed

- Lower operating speed while loading, unloading or performing heavy operations.
- Keep load low and move at slow speeds on rough or uneven terrain.

## Avoid Rollover

The equipment may rollover, resulting in death or serious injury. To help prevent rollover:

- Travel at a slow speed.
- Avoid sharp turns & sudden movement on slopes.
- Carry loads close to the ground.
- Avoid holes, ditches and other obstructions which may cause equipment to rollover.
- Balance load so weight is evenly distributed and load is stable.
- Use caution when operating on slopes and do not operate on excessively steep slopes.
- Do not exceed load capacity of equipment.

## Avoid Powerlines & Underground Utilities

- Check clearance before raising equipment.
- Have local utilities locate and mark buried wires, cables, pipelines and other hazards before grinding.



### **DANGER**

**Prevent electrocution.**

**Death or serious injury can result if equipment comes near or contacts power lines.**

**Electrocution can occur without direct contact.**

DO NOT leave the operator's seat if any part of the equipment contacts electric lines or cables.

## Detach Stump Grinder Safely

Detach stump grinder on a firm and level surface. Stump grinder may fall over if detached on sloping or soft surface. Be sure people, livestock and pets are clear of machinery.

Relieve hydraulic pressure before disconnecting hydraulic hoses. See your skid steer Operator's Manual.

## Raised Attachment



### **WARNING**

**Crushing hazard.**

**Raised, unsupported stump grinder can fall, resulting in death or serious injury.**

**Never enter the area under a raised stump grinder unless properly supported.**

A raised stump grinder can lower unexpectedly, resulting in death or serious injury.

NEVER enter area under a raised stump grinder unless stump grinder is properly and safely supported.

Lower stump grinder to ground, engage parking brake, shut off engine and remove key before servicing.

## Avoid Loud Noise



### **WARNING**

**Prolonged exposure to loud noise can cause impairment or loss of hearing.**

**Wear a suitable hearing protective device such as earmuffs or earplugs to protect against objectionable or uncomfortable loud noises.**



## Hazards from Modifying Equipment

Do not make any alterations to your stump grinder. Altering the equipment may cause unsafe conditions and may void the manufacturer's warranty.

## Avoid High Pressure Fluids



### WARNING

**Pressurized fluids can penetrate the skin.**

**Hydraulic hoses can fail from age, damage and exposure.**

**Use body and face protection while searching for leaks. A tiny, almost invisible leak can penetrate the skin, thereby requiring immediate medical attention.**

**Use wood or cardboard to detect hydraulic leaks, never use your hands.**

hydraulic lines. Verify all connections are tight before applying pressure.

Search for leaks with a piece of cardboard or wood.

Protect hands and body from high pressure fluids. If an accident occurs, see a doctor immediately. Any fluid injected into the skin must be surgically removed within a few hours or serious infection may result.

## Avoid Wood Dust Inhalation



### WARNING

**Wear an approved respirator (N95 Type as a minimum).**

**Follow local, state and federal regulations.**

The health effects from exposure to wood dust are due to chemicals in the wood or chemical substances in the wood created by bacteria, fungi, or molds.

Escaping fluid under pressure can penetrate the skin causing serious injury.

Prevent the hazard by relieving pressure (See skid steer Operator's Manual.) before connecting or disconnecting

## 2.3 Maintenance Hazards

### Maintenance

Before servicing, park machine on a firm and level surface, set parking brake, chock wheels, and place a “Do Not Operate” tag on control panel. Read and understand this manual. If you do not understand any part of the manual, contact Baumalight at 866-820-7603.

Always wear face and/or eye protection, safety shoes, and other protective equipment appropriate for the job.

Do not make unauthorized modifications. Contact Baumalight at 866-820-7603 before you weld, cut/drill holes, or make any other modifications.

Always use Baumalight replacement parts.



#### **WARNING**

**Moving parts can crush and cut.**

**Keep clear of moving components.**

**Follow lockout procedure before servicing.**



#### **WARNING**

**Crushing hazard.**

**Before performing inspections, service or maintenance:**

- **Park machine on firm, level surface.**
- **Engage parking brake.**
- **Turn engine off and remove key.**
- **Place “Do Not Operate” tag on control panel.**



#### **WARNING**

**Entanglement hazard.**

**Keep clear of moving components.**

**Wear proper protective equipment appropriate for the job.**



#### **WARNING**

**Burn hazard.**

**Hot and high pressure hydraulic oil.**

**Allow oil to cool before servicing.**



### 3 SAFETY SIGNS

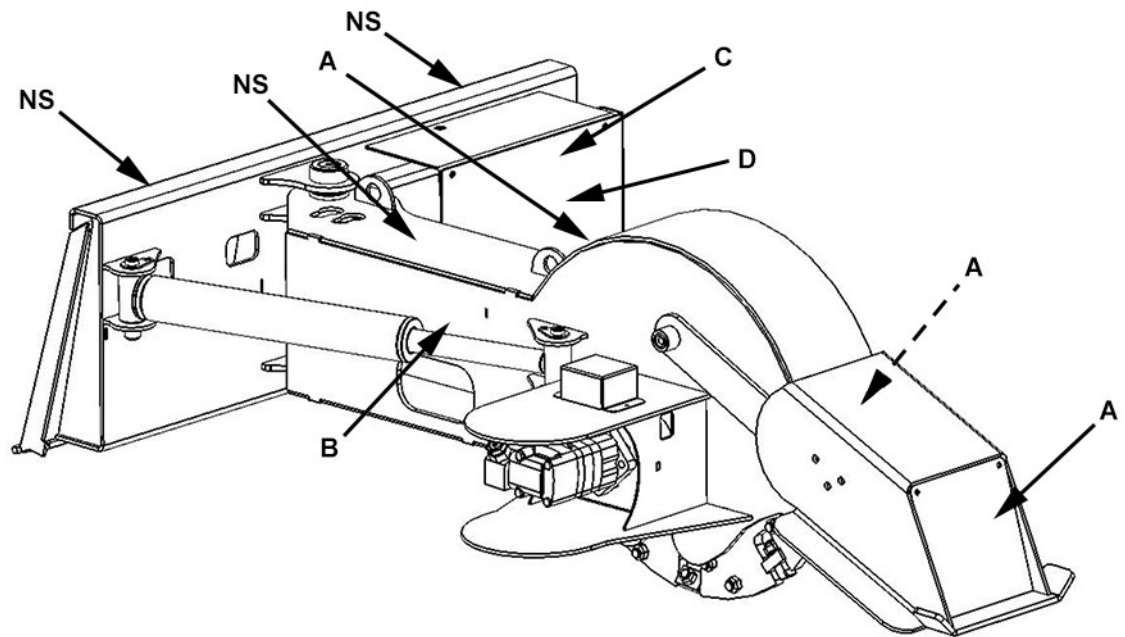

NS. Non-Slip Pad

Dashes lines indicate items hidden from view.



A. MTB-108 Safety Sign



B. MTB-180 Safety Sign



C. MTB-182 Safety Sign

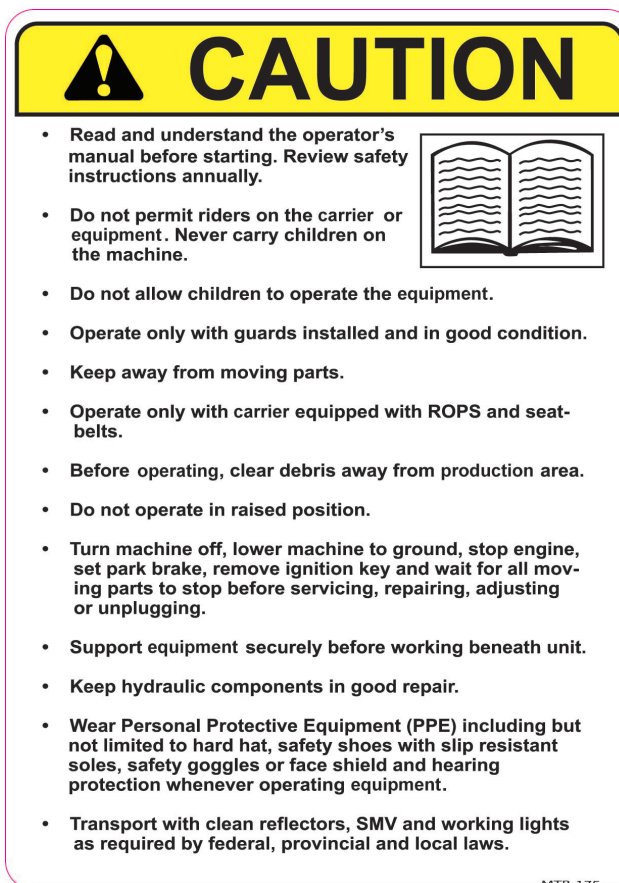

D. MTB-181 Safety Sign

## 4 Assembly

### 4.1 Remove Shipping Dunnage and Parts

#### **WARNING**

Approximate weight of grinder is:

- S24 - 852 lbs (386 kg)
- S28 - 995 lbs (451 kg)

Stump Grinder is top heavy when attached to pallet. Move with caution.

Do not position feet around or under pallet.

To prevent injury from accidental lowering of grinder, attach an adequate lifting device to lifting eye on stump grinder.

1. Remove crate material from pallet.
2. Attach lifting strap or chain to lifting eye (A) on stump grinder.
3. Remove all shipping bands, wires and loose parts from around stump grinder.

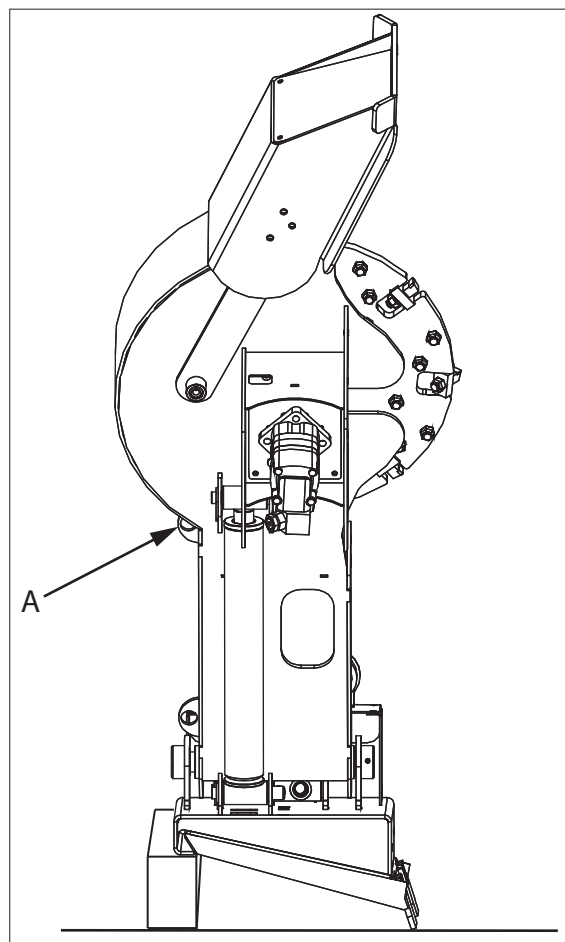

## 4.2 Remove Stump Grinder From Pallet

1. Slowly lift the weight of stump grinder off the pallet.  
Remove pallet from work area.
2. Lower stump grinder, so that the rotor reaches the ground.
3. Stabilize the machine and continue lowering the rest of the way down.
4. Remove lifting device.

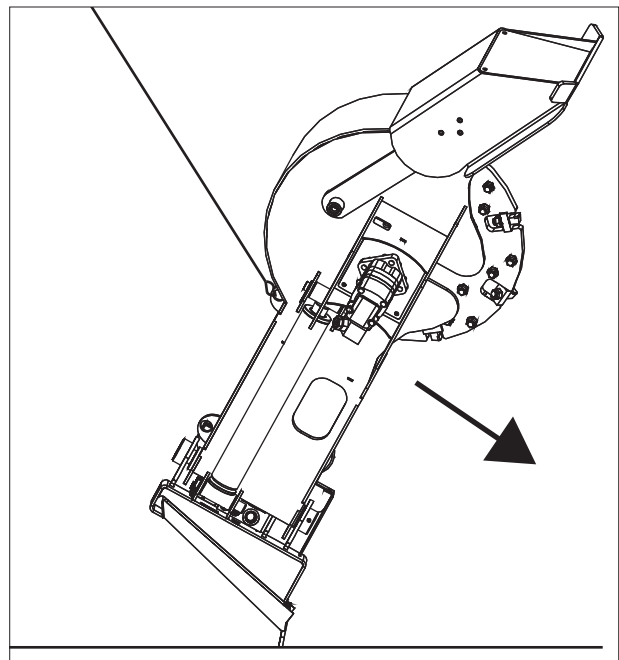

# 5 OPERATION

## 5.1 Preparation for Use



### WARNING

**Wear an approved respirator (N95 Type as a minimum).**

**Follow local, state and federal regulations.**

**The health effects from exposure to wood dust are due to chemicals in the wood or chemical substances in the wood created by bacteria, fungi, or molds.**

Although the Stump Grinder has been carefully inspected and checked prior to shipment from manufacturer, it is recommended that the unit be thoroughly inspected.

Check all bolts for tightness and remove all shipping tags, bags, skids, and blocking. Check swing frame to ensure that

it is free from obstruction and can operate smoothly without binding.

Remove any masking materials affixed during painting. Inspect the skid steer and any accessory equipment to verify that nameplates and all safety warning, caution signs and decals provided with the equipment are in place and clearly visible.

Verify the quick-tach handles are locked.

Visually inspect the unit before each start up. Check for loose or missing parts and any damage that may have occurred during moving or shipping.

Review all skid steer pre-start instructions, and verify that all recommended steps and procedures have been followed.

Never bar over the rotor, This could cause damage and result in personal injury or equipment damage.

**NOTE:** Always keep the weight of the machine in mind. Never position body in line of impact.



## 5.2 Pre-Operation Check List

Check-mark	Check these items:	Frequency
	Verify the quick attach handles are locked.	Each operation.
	Check the hydraulic fluid level to verify there is sufficient fluid in the system.	Each operation.
	Check hydraulic lines for breaks and punctures.	Each operation.
	Verify hydraulic lines are plugged in securely.	Each operation.
	Verify hydraulic lines are tied well away and cannot bind or be pinched.	Each operation.
	Check the cross bolts that secure the 6 pivot pins.	Each operation.
	Check swing control function.	Each operation.
	Verify the cutting tips on the cutting wheel are tight.	Every 4 hours.
	Grease 2 pins on the deflector shield.	Every 6 hours.
	Grease all 6 pivot pins.	Every 10 hours.

## 5.3 Machine Components

- A. Quick Attach
- B. Manual Storage Tube
- C. Cutting Wheel Shield
- D. Debris Shield
- E. Cutting Wheel
- F. Hydraulic Motor
- G. Swing Cylinder

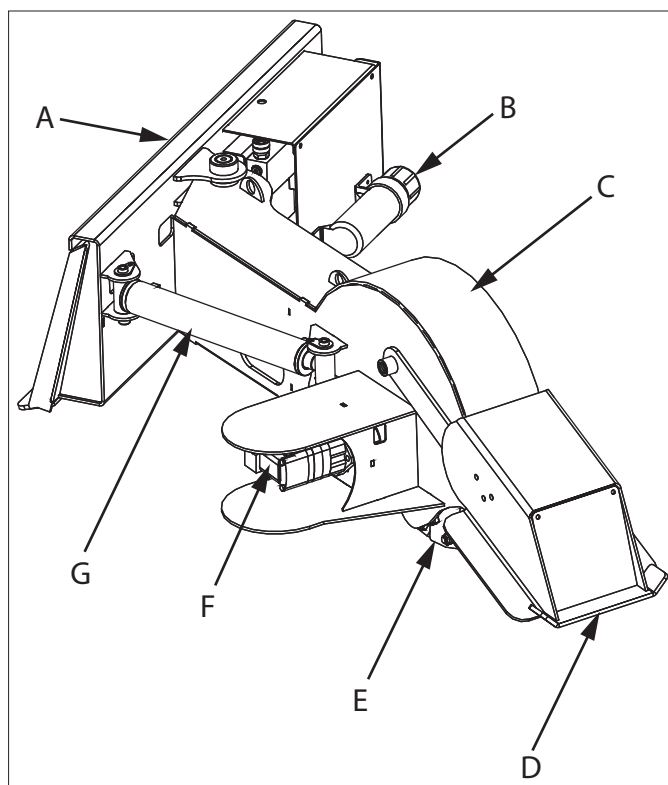

## 5.4 Attaching Stump Grinder To Skid Steer



### WARNING

**Prevent injury.**

**Never position yourself between skid steer and stump grinder.**

**Only experienced and properly trained operator's should operate the skid steer and stump grinder.**

1. Read ALL Safety instructions.
2. Check for loose teeth or any other loose parts
3. Verify hydraulic lines are clear of pinch areas.
4. Verify there is sufficient visibility and maneuverability to move up to the stump grinder.
5. Verify pins are secure in the correct position.
6. Attach skid steer to stump grinder. See skid steer Operator's Manual.
7. Connect hydraulic hoses to the skid steer SCV's. See your skid steer Operator's Manual. Verify hydraulic hoses are clear of pinch areas.
8. Connect swing control.
9. Move to a clear open area to test functions.



### WARNING

**Pressurized fluids can penetrate the skin.**

**Hydraulic hoses can fail due to physical damage, age, kinks and exposure. Check hoses regularly. Replace damaged hoses.**

**Use body and face protection while searching for leaks. A tiny, almost invisible leak can penetrate the skin, thereby requiring immediate medical attention.**

**Use wood or cardboard to detect hydraulic leaks, never use your hands.**

## 5.5 Detaching Stump Grinder From Skid Steer



### WARNING

**Prevent serious injury or death caused by unexpected movement:**

- 1. Park skid steer on a level surface.**
- 2. Engage skid steer park brake.**
- 3. Disengage hydraulic flow.**
- 4. Shut off engine and remove key.**

1. Park skid steer on a level surface.
2. Lower grinder to the ground.
3. Shut off engine and remove key.
4. Relieve hydraulic pressure. See your skid steer Operator's Manual.
5. Disconnect hydraulic hoses.
6. Disconnect swing control.
7. Disconnect skid steer from stump grinder. See skid steer Operator's Manual.

## 5.6 Transporting

1. Verify all reflectors and Slow Moving Vehicle (SMV) sign are visible.
2. Raise stump grinder to transport position.
3. Center the grinder directly in front of the skid steer for greater stability.
4. Verify grinder power is disengaged.
5. Travel at a reasonable and safe speed.



### **WARNING**

**To prevent bodily injury from rotating cutting wheel, be sure to disengage power before transporting grinder.**

## 5.7 Carbide Teeth Break-In

During the first few hours of use, avoid hitting stones as much as possible to allow the carbide teeth to wear slightly. This can be done by keeping the cutting wheel above ground level. Brand new carbide tips are razor sharp and can chip and shatter easily when they hit hard objects. Once the razor sharpness has worn away, the tips do not chip as easily. Observing these precautions will extend the life of the carbide teeth and reduce operating expenses.

## 5.8 First Time User Tips

Before you begin, make sure the skid steer is turned off and hydraulic flow is disengaged.

Remove cover to access electric/hydraulic valve. Flow control (A) adjusts the cutting speed. Turn knob (A) clockwise to slow the cutting speed. The cutting speed should slow for a new operator and can be adjusted with experience. Install access cover.

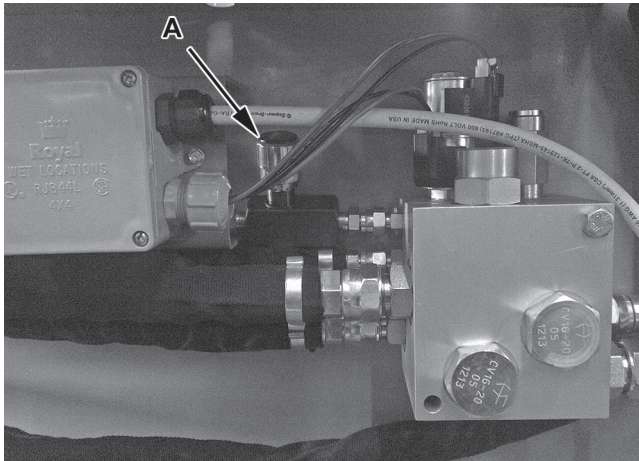

Stand to the side of the stump grinder and observe the center point on the bottom of the cutting wheel. Now sit on the skid steer seat and observe the center point again. This point will appear different depending on where you are positioned. This can be very deceiving! Familiarize yourself with the view of the stump grinder from the skid steer seat.

Test all operating functions in an open area with the skid steer at idle speed to get a feel for the controls. Take your time.

Reference the cutting chart on [baumalight.com](http://baumalight.com) to get an approximate grinding for cutting stumps.

Start with a small stump. Make the first pass then disengage hydraulic flow and get off the skid steer to see how much you have removed.

Get off the skid steer after each pass to check the progress. The cutting wheel is shielded from view when sitting on the skid steer seat so it is difficult to accurately determine the progress. The ability to judge the positioning improves with practice. Do not expect to get the first stump done quickly.

### **WARNING**

**Always turn off the skid steer and disengage hydraulic flow before getting off the seat and approaching the cutting wheel.**

### **WARNING**

**Wear an approved respirator (N95 Type as a minimum).**

**Follow local, state and federal regulations.**

**The health effects from exposure to wood dust are due to chemicals in the wood or chemical substances in the wood created by bacteria, fungi, or molds.**

## 5.9 Field Operation

### **WARNING**

Prevent serious injury or death caused by unexpected movement:

1. Park skid steer on a level surface.
2. Engage skid steer park brake.
3. Disengage hydraulic flow.
4. Shut off engine and remove key.

### **WARNING**

Never operate skid steer when other people are in the vicinity.

Do not allow riders on skid steer.

### **WARNING**

Never operate stump grinder when other people are in the vicinity. Debris can be thrown several feet from cutting area. Keep all shields in place.

### **WARNING**

Clean machine thoroughly before service or maintenance procedures.

The health effects from exposure to wood dust are due to chemicals in the wood or chemical substances in the wood created by bacteria, fungi, or molds.

1. Attach stump grinder to skid steer. See Attaching/ Detaching in this section.
2. If stump is on a grade, position skid steer in low area. This will position stump grinder in high area for a greater advantage of weight for stable cutting.
3. Move over stump so cutting wheel torques downward pushing frame up to avoid binding.
4. Engage cutting wheel and slowly lower it in a controlled manor to desired cutting depth. Always lower cutting wheel beside stump, never try cutting down, always cut from the side.
5. Move sweep control switch (A) to move rotor into the stump.

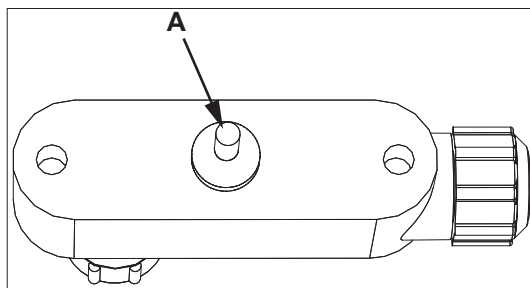

6. If cutting wheel stalls, stop motion and retract sweep slightly.
7. After a complete pass, move sweep control switch to retract sweep and lower cutting wheel to desired position for next pass.

Continue the passes in this manor until sump is completely removed.



## WARNING

**Always turn off the skid steer before getting off the seat and approaching the cutting wheel.**

8. Disengage skid steer hydraulic flow. Shut off engine and remove key.
9. Get off the seat and check the position of the stump grinder to the stump. Verify the grinder is positioned at the edge of the stump that is closest to the skid steer.



## WARNING

**Raising the deflector guard can allow debris to travel a long distance. Be aware of your surroundings.**

**Note:** If you are working close to a fence or building, the deflector guard (A), that directs debris, can be flipped up.

10. Get back on the skid steer and turn it on. Engage hydraulic flow. .
11. Using the skid steer lift and swing control to direct the stump grinder, make the first pass across the front edge of the stump, moving the cutting wheel from right to left in 3 to 6 inch passes. The size of the pass will depend on the hydraulic flow and hydraulic presure of the skid steer. Return the grinder to the far right after each pass.
12. Continue to take passes across the front edge of the



stump (end away from skid steer), taking 3-6 inches on each pass.

13. When ground level is reached, continue to grind 3 – 6" below the surface to the bottom of the stump where the roots branch out.
14. Lift the stump grinder and swing it to the far right. Back the skid steer up slightly to position the stump grinder beside the new front edge of the stump.
15. Make multiple passes over the front edge of the stump, taking 3-6 inches on each pass.
16. Reposition the skid steer and stump grinder as needed until the entire stump has been removed to below ground level.
17. Follow the roots, taking as much of the larger surface roots as possible. If these are not removed they can, over time, protrude from the ground in areas where there is a heavy freeze/thaw cycle.
18. Throttle down the skid steer to an idle.
19. Disengage skid steer hydraulic flow.
20. Shut off engine and remove key.



#### **WARNING**

**Never approach stump grinder before cutting wheel has come to a complete stop.**

## 6 SERVICE and MAINTENANCE

### 6.1 Service



#### **DANGER**

**Support grinder frame with safety stands to prevent accidental lowering. Do not position stands under cutting wheel because it can rotate.**

**Never enter area under grinder.**

**Support cutting wheel deflector guard, so shield does not accidentally fall.**

Prevent the hazard by relieving pressure (See skid steer Operator's Manual.) before connecting or disconnecting hydraulic lines. Verify all connections are tight before applying pressure.

Protect hands and body from high pressure fluids. If an accident occurs, see a doctor immediately. Any fluid injected into the skin must be surgically removed by a professional physician within a few hours or serious infection may result.



#### **WARNING**

**Pressurized fluids can penetrate the skin.**

**Hydraulic hoses can fail due to physical damage, age, kinks and exposure. Check hoses regularly. Replace damaged hoses.**

**Use body and face protection while searching for leaks. A tiny, almost invisible leak can penetrate the skin, thereby requiring immediate medical attention.**

**Use wood or cardboard to detect hydraulic leaks, never use your hands.**



#### **WARNING**

**Prevent serious injury or death caused by unexpected movement:**

- 1. Park skid steer on a level surface.**
- 2. Engage skid steer park brake.**
- 3. Disengage hydraulic flow.**
- 4. Shut off engine and remove key.**



#### **WARNING**

**Clean machine thoroughly before service or maintenance procedures.**

**The health effects from exposure to wood dust are due to chemicals in the wood or chemical substances in the wood created by bacteria, fungi, or molds.**

### 6.1.1 Replace Cutting Teeth

1. Park skid steer and grinder on a level surface.
2. Lower grinder to the ground.
3. Support grinder frame with safety stands.
4. Shut off engine and remove key.
5. Inspect cutting teeth for damage. Replace individual teeth as needed.
6. Remove lock nut (B) and cutting tooth (A).
7. Install replacement tooth and lock nut.

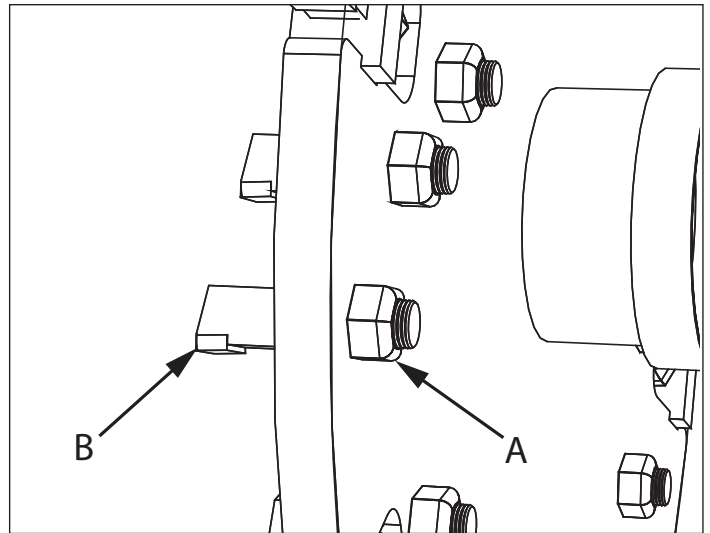

**Note:** Parts breakdown can be found on BaumaLight's website. [www.baumalight.com](http://www.baumalight.com)

### 6.1.2 Replace Spider

1. Park skid steer and grinder on a level surface.
2. Lower grinder to the ground.
3. Support grinder frame with safety stands.
4. Shut off engine and remove key.
5. Remove four cap screws (B) and remove hydraulic motor assembly (A).
6. Remove and replace spider (C).
7. Attach motor assembly in reverse order of removal.

**Note:** Parts breakdown can be found on BaumaLight's website. [www.baumalight.com](http://www.baumalight.com)

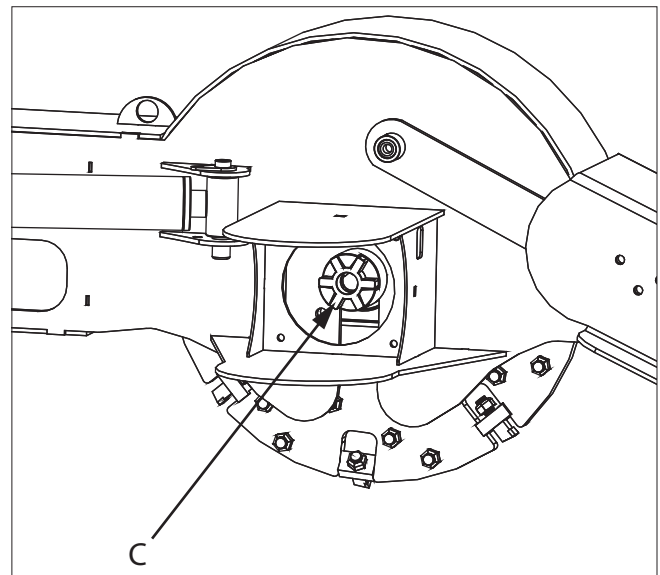
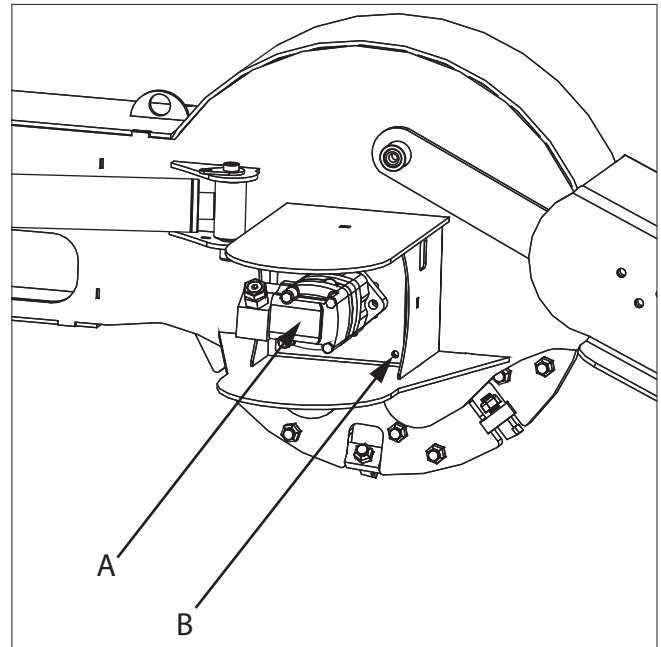

### 6.1.3 Replace Hydraulic Hoses

1. Park skid steer and grinder on a level surface.
2. Lower grinder to the ground.
3. Shut off engine and remove key.
4. Relieve hydraulic pressure. See your skid steer Operator's Manual.
5. Disconnect hydraulic hoses from skid steer.



#### CAUTION

**Fall hazard.**

**Spilled fluids may be slippery. Clean up spilled fluid immediately.**

6. Drain hydraulic hose at its lowest point. Drain oil into a suitable container. Clean any spilled fluids immediately.
7. Remove hose from cylinder.
8. Remove quick coupler and/or adapter from hose.
9. Install replacement hose in reverse order of removal.

**Note:** Parts breakdown can be found on BaumaLight's website. **[www.baumalight.com](http://www.baumalight.com)**

## 6.2 Maintenance

Maintenance Chart		
General Inspection	Inspect the unit for any buildup of contamination (dirt, stones, etc.).	Daily
Hydraulics	Check hydraulic hoses and fittings for leaks.	Daily
Cutting Teeth	Check and replace one at a time as necessary. The teeth on the outer edge of the wheel wear faster and are more prone to chipping. With daily use, expect to replace 5 to 10 teeth per week (See Replace Cutting Teeth in this section.)	Every 2 hours.
Deflector Shield Pins	Lubricate pins so deflector can move freely.	Every 6 hours.
Pivot Pins	Lubricate nine (6) pivot pins.	Every 10 hours.
Cutting Wheel Retaining Nut	Torque to 176-190 N•m (130-140 lb-ft.)	Only if cutting wheel is replaced.

### 6.2.1 Every 6 Hours

Lubricate deflector shield pivot points every 6 hours of use.

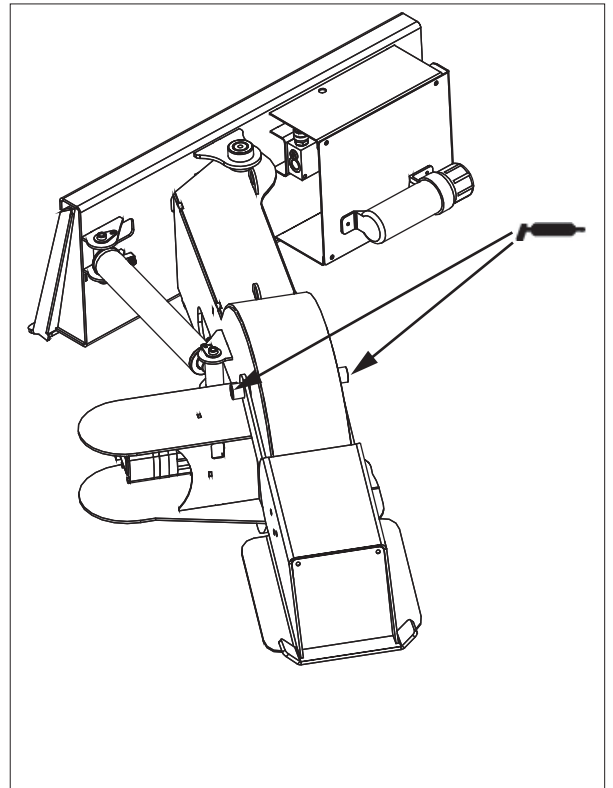

### 6.2.3 Every 10 Hours

Lubricate pivot pins every 10 hours of use.

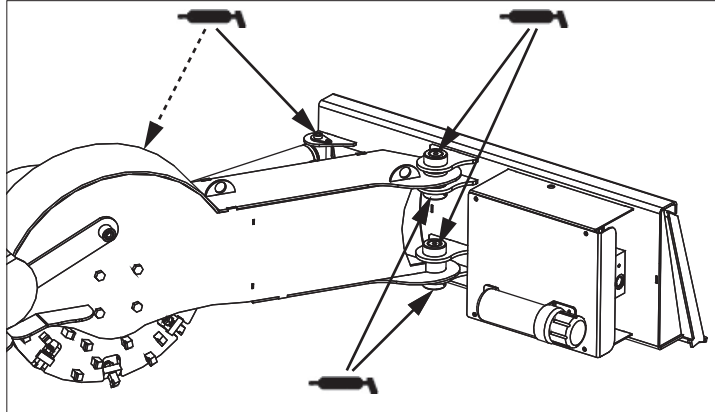



## 7 TROUBLESHOOTING

PROBLEM	CHECK	SOLUTION
Cutting wheel does not spin.	Cutting wheel jammed.	Remove material from cutting wheel.
	Low oil.	Check oil level in skid steer. Add if necessary.
	Not enough oil flow.	Check flow control on skid steer. See your dealer.
Cutting wheel does not have much power.	Low oil.	Check oil level in skid steer. Add if necessary.
	Oil filter plugged.	Replace skid steer oil filter.
	Relief valve not set properly.	Set relief valve. Pressure should be between 2,500 and 3,500 psi.
	Low oil flow and pressure.	Check flow control on skid steer. See your dealer.
No movement on cylinders.	No oil flow.	Check for plugged or reversed hydraulic lines.
	Fuse blown on swing control.	Replace fuse.

## **8 STORAGE**

### **8.1 Storing Grinder (End of Season)**

1. Store Grinder in a dry place.
2. Clean grinder thoroughly. Dirt and wood chips will draw moisture and cause rust.
3. Lubricate machine. (See Service and Maintenance section.)
4. Check condition of cutting teeth. Replace as necessary. (See Service and Maintenance section.)
5. Check for loose or missing hardware.
6. Paint parts as necessary.

### **8.2 Removing Grinder from Storage (Beginning of Season)**

1. Review Operator's manual and check adjustments.
2. Lubricate machine. (See Service and Maintenance section.)
3. If parts have been replaced, verify they run properly.

## 9 SPECIFICATIONS

Model Number	S24	S28
Recommended HP (kW)	30-80 (22-60)	50-120 (37-89)
Maximum HP (kW)	Check GPM & PSI	
Hydraulic GPM (LPM)	20-30 (76-114)	26-40 (98-151)
Cutting Wheel	24 in. (610 mm)	24 in. (610 mm)
Number of Teeth	34	34
Tooth Construction	Carbide Steel Bolt-In	
Cutting Wheel Speed	700 RPM	800 RPM
Cutting Height (Above Ground)	No Limit	
Cutting Depth (Below Ground)	10 in. (254 mm)	10 in. (254 mm)
Maximum Cutting Depth (Per Pass)	6 in. (152 mm)	6 in. (152 mm)
Maximum Horizontal Cut	22 in. (559 mm)	22 in. (559 mm)
Swing Arc	80°	
Hub Torque	250 ft-lbs. (339 N•m)	250 ft-lbs. (339 N•m)
Over Torque Protection	Relief Valve	
Hitch	Quick Attach	
Number of Remotes Required (Hydraulic)	1	
Requires 12 Volt DC	Yes	
Shipping Weight	852 lb (386 kg)	995 lb (451 kg)

# 10 WARRANTY

This product is warranted to be free of defects in materials and workmanship under normal use and service, for a period of one year from the date of purchase, when operated and maintained in accordance with the Operating and Maintenance Instructions supplied with this unit. This warranty does not cover misuse or negligence.

Under no circumstances will the manufacturer be liable for any consequential damage or expense of any kind, including loss of profits. The manufacturer is under no circumstances liable for skid steer damage of any kind. The manufacturer is not liable for the maintenance of the product.

This warranty is extended only to the original purchaser. Warranty is void if repairs are attempted by anyone other than an Authorized Service Center.

If a difficulty develops with the product, you should contact your nearest Authorized Repair Centre, or distributor. Only these locations are authorized to make repairs to the product or affect the replacement of defective parts, which will be done at no charge within a reasonable time after the receipt of the product. Units or parts should be returned at the customer's expense to the nearest repair location or Authorized Service Centre. Pack unit in a strong carton and pad tightly to avoid damage. Damage in-transit is not covered by warranty. Include original purchase receipt with any claim (keeping a copy for your files).

The Manufacturer's Liability is limited to repair of the product and/or replacement of parts and is given to the purchaser in lieu of all other remedies including incidental and consequential charges. There are no warranties, expressed or implied other than those specified herein. For the nearest Authorized Service Centre call the manufacturer.

Please note the following details and file this information in an appropriate place.

Model Number: \_\_\_\_\_ S/N: \_\_\_\_\_

Date of Purchase: \_\_\_\_\_ Owner's Name \_\_\_\_\_



MTB MFG INC.  
CORPORATE HEADQUARTERS  
4575 Powell Rd.,  
Wallenstein, Ontario Canada  
N0B 2S0  
Phone - 519.698.9864  
Toll Free - 866.820.7603  
Fax - 519.698.1087  
[www.baumalight.com](http://www.baumalight.com)

